

- LEGEND:**
- STOKA MARK
 - P.C. PILE
 - BENCH MARK
 - UTILITY BOX
 - WATER VALVE
 - FIRE DEPARTMENT CONNECTION
 - FIRE HYDRANT
 - TRANSFORMER
 - MAIL BOX
 - INVERTER
 - SIGN
 - LIGHT POLE
 - UTILITY POLE
 - STOP MARK
- EDGE OF BITUMINOUS CONCRETE PAVEMENT
 --- SANITARY SEWER LINE
 --- STOKA MARK
 --- OVERHEAD WIRE
 --- STOP MARK

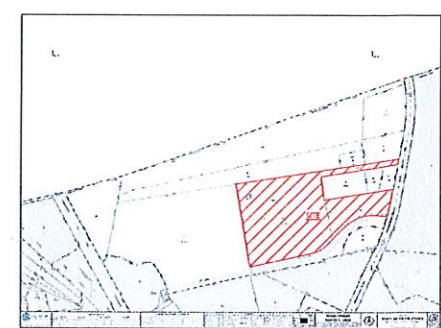

S-B-L	AREA	ACRES
COMB. LOTS 11.2 & 11.3	805724.65 SQ. FT.	18.49
65.14-1-11.2	647793.24 SQ. FT.	14.87
65.14-1-11.3	157931.41 SQ. FT.	3.62

- NOTES:**
- THIS SURVEY DOES NOT PURPORT TO IDENTIFY, IF ANY, ENCROACHMENTS, WETLANDS, UTILITIES, SERVICE LINES OR STRUCTURES BELOW GROUND.
 - PROPERTY SUBJECT TO DOCUMENTS OF RECORD.
 - NO ATTEMPT WAS MADE TO DETERMINE IF ANY PORTION OF THIS PROPERTY IS CLAIMED BY THE STATE OF N.Y. AS TIERLAND.
 - NO RESPONSIBILITY OR LIABILITY IS ASSUMED BY THE LAND SURVEYOR FOR ANY OTHER PURPOSE INCLUDING, BUT NOT LIMITED TO USE OF SURVEY FOR SURVEY ADJUDICATION, RESALE OF PROPERTY, OR TO ANY OTHER PERSON NOT LISTED IN THE CERTIFICATION EITHER DIRECTLY OR INDIRECTLY.
 - ONLY COPIES FROM THE ORIGINAL SURVEY MARKED WITH AN ORIGINAL PROFESSIONAL LAND SURVEYOR'S EMPLOYED SEAL SHALL BE CONSIDERED VALID COPIES. SIGNATURE AND EMPLOYED SEAL SIGNIFY THAT THE SURVEY WAS PREPARED IN ACCORDANCE WITH THE EXISTING CODE OF PRACTICE ADOPTED BY THE NEW YORK STATE BOARD OF PROFESSIONAL ENGINEERS AND LAND SURVEYORS.
 - UNAUTHORIZED ALTERATION OR ADDITION TO A SURVEY MAP BEARING A LICENSED PROFESSIONAL LAND SURVEYOR'S SEAL IS A VIOLATION OF SECTION 7004, SUBSECTION 2 OF THE NEW YORK STATE EDUCATION LAW.
 - OFFICES SHOWN HEREON ARE NOT TO BE USED AS A BASIS FOR ANY CONSTRUCTION OF PERMANENT STRUCTURES (E. BUILDINGS, SHEDS, FENCES, ETC.) SUBJECT TO EASEMENTS & RESTRICTIONS OF RECORD, IF ANY.
 - HORIZONTAL DATUM IS NAD83. N-EAST AND VERTICAL DATUM IS NAVD83.

RECORD OWNER
 GOLDEN KRUST ROCKLAND LLC
 622 ROUTE 303 & 9 AL FOLIE WAY
 BLAUBELT, NY 10903
 SRL 65.14-1-11.2 & 65.14-1-11.3

CERTIFICATION:
 I HEREBY CERTIFY TO THE PARTIES OF INTEREST BELOW THAT THIS PLAN IS BASED ON A SURVEY AND MAPS OF RECORD ON FILE WITH CLEARPOINT SERVICES LLC. (UNDER THE DIRECTION OF JOHN W. MCCORD, SP., P.L.S.) AND AN ACTUAL FIELD SURVEY COMPLETED ON FEBRUARY 27, 2022.

JOHN W. MCCORD, SP., P.L.S.
 NEW YORK LICENSE NO. 050904

PLANNING BOARD MEETING OF:
OCT 25 2023
Town Of Orangetown

JOHN W. MCCORD, SP.
 PRELIMINARY

CLEARPOINT SURVEYING, D.P.O.
 Professional Land Surveyor
 1400 North Main Street | Jackson, NJ 07033
 New York Office | 225 South Avenue | Suite 201 | Orangetown, NY 10904
 Phone: (845) 341-1111 | Fax: (845) 341-1112 | Email: info@clearpointny.com
 www.clearpointny.com

SHEET 1 OF 1
 LOT CONSOLIDATION PLAN
 PREPARED FOR
622 NEW YORK 303
- SECTION 65.14 - BLOCK 1 -
- LOTS 11.2 & 11.3 -
 SITUATED IN THE
 TOWN OF ORANGETOWN,
 ROCKLAND COUNTY, NEW YORK

PROFESSIONAL LAND SURVEYOR NEW YORK LICENSE NO. 050904
 CERTIFICATE OF AUTHORIZATION No. 0019196
 JOB NO. 22-34219 DATE: 09-22-2023 SCALE: 1"=60' STARS NO. 22-34219 SHEET 1 OF 1 PW - RG

