

TAX LOT: SECTION 77.10, BLOCK 3, LOT 76J
REFERENCES:

ALL BOUNDARY & TOPOGRAPHY INFORMATION IS REFERENCED FROM A SURVEY PREPARED BY ROBERT E. SORACE, PLS LAST REVISED AUGUST 9, 2022.

NOTE:
1. IF NECESSARY SHEETING WILL UTILIZED TO NOT HAVE ANY EFFECT ON THE NEIGHBORING PROPERTIES DURING CONSTRUCTION OF THE DWELLING.
2. A PERCOLATION TEST MUST BE PERFORMED BEFORE INSTALLATION OF THE DRAINAGE SYSTEM.

PROP. COVERAGE:
DWELLING, DECK, WALK &
DRIVEWAY EXPANSION=1.891 SF

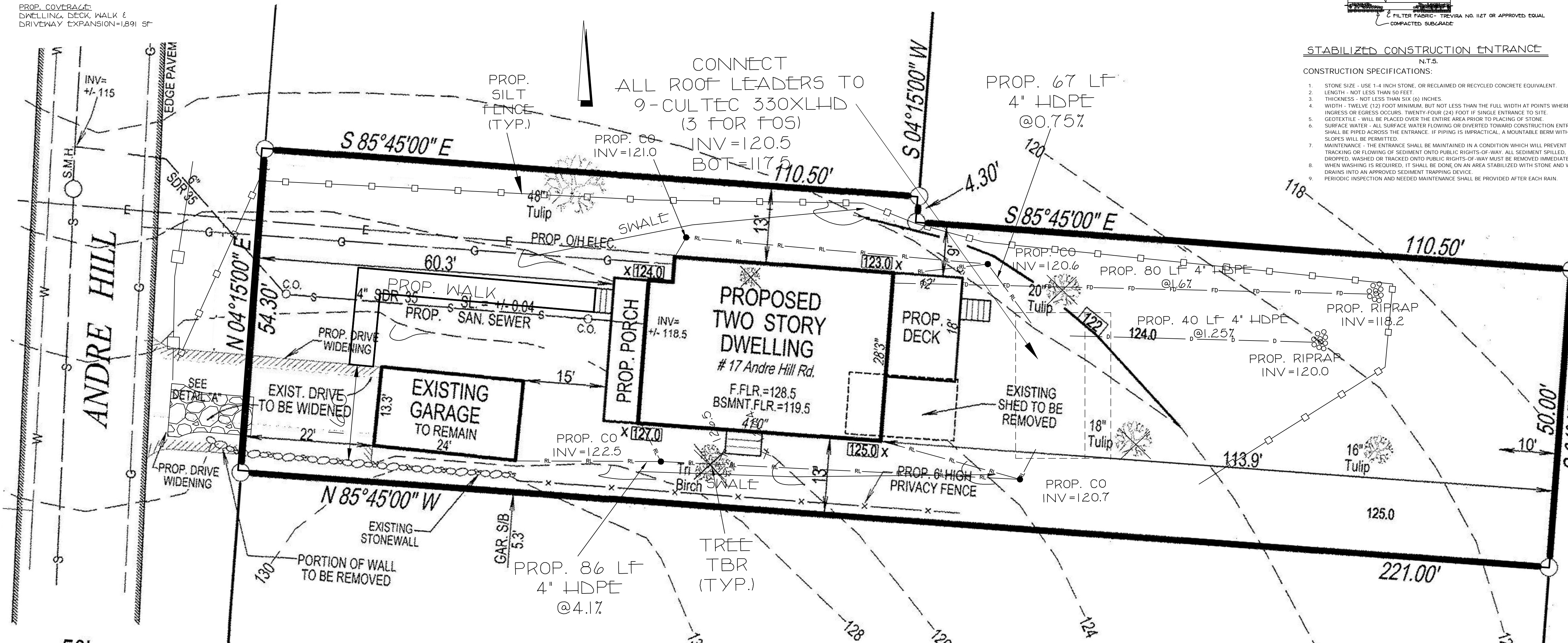

STABILIZED CONSTRUCTION ENTRANCE
N.T.S.

- CONSTRUCTION SPECIFICATIONS:
1. STONE SIZE - USE 1-4 INCH STONE, OR RECLAIMED OR RECYCLED CONCRETE EQUIVALENT.
2. LENGTH - NOT LESS THAN 50 FEET.
3. THICKNESS - NOT LESS THAN SIX (6) INCHES.
4. WIDTH - TWELVE (12) FOOT MINIMUM, BUT NOT LESS THAN THE FULL WIDTH AT POINTS WHERE INGRESS OR EGRESS OCCURS. TWENTY FOUR (24) FOOT IF SINGLE ENTRANCE TO SITE.
5. GEOTEXTILE - WILL BE PLACED OVER THE ENTIRE AREA PRIOR TO PLACING OF STONE.
6. SURFACE WATER - ALL SURFACE WATER FLOWING OR DIVERTED TOWARD CONSTRUCTION ENTRANCES SHALL BE PIPED ACROSS THE ENTRANCE. IF PIPING IS IMPRACTICAL, A MOUNTABLE BERM WITH 5:1 SLOPES WILL BE PERMITTED.
7. MAINTENANCE - THE ENTRANCE SHALL BE MAINTAINED IN A CONDITION WHICH WILL PREVENT TRACKING OR FLOWING OF SEDIMENT ONTO PUBLIC RIGHTS-OF-WAY. ALL SEDIMENT SPILLED, DROPPED, WASHED OR TRACKED ONTO PUBLIC RIGHTS-OF-WAY MUST BE REMOVED IMMEDIATELY. WHEN WASHING IS REQUIRED, IT SHALL BE DONE ON AN AREA STABILIZED WITH STONE AND WHICH DRAINS INTO AN APPROVED SEDIMENT TRAPPING DEVICE.
8. PERIODIC INSPECTION AND NEEDED MAINTENANCE SHALL BE PROVIDED AFTER EACH RAIN.

Detention Design:	
Watershed "C"	
Development size =	0.0434 Acre
Undeveloped SCS Curve No =	74.0000
Developed SCS Curve No =	89.0000
Rain event	
100 year, 24-hour	9.3000
Type of subsurface disposal system:	
Cullec w/ 6" stone	
3. Determine Percolation Rate:	
Percolation Rate:	1.0000 inches
Time	30.0000 minutes
a. Area of Percolation (A _p):	
Surface area of Cylinder	A _c =P _d h _{avg}
D =	1.0000 foot
P _d =	8.5000 inches
Bottom Area	A _b =P _d ² /2
A _p =	0.7854 Ft ²
Volume of Percolation:	
A _p h = A _c h	3.0107 Ft ³
A _b h =	0.0654 Ft ³
V _p = A _p h	
Soil Percolation Rate	S _r = volume/area*time
S _r =	0.0007 Ft ³ /Ft ² /Min.
S _r = (minus clogging factor of 25%)	0.7825 Ft ³ /Ft ² /day
4. Calculate Required Storage Volume:	
100yr, 24 hour rainfall =	9.3000 inches
From Table 2-1 of TR-55	74.0000 therefore depth V _r = 6.11 inches
Existing CN =	89.0000 therefore depth V _r = 9.10 inches
Proposed CN =	
Delta V _r =	2.9900 inches
V _s = delta V _r * Area	471.1742 Ft ³

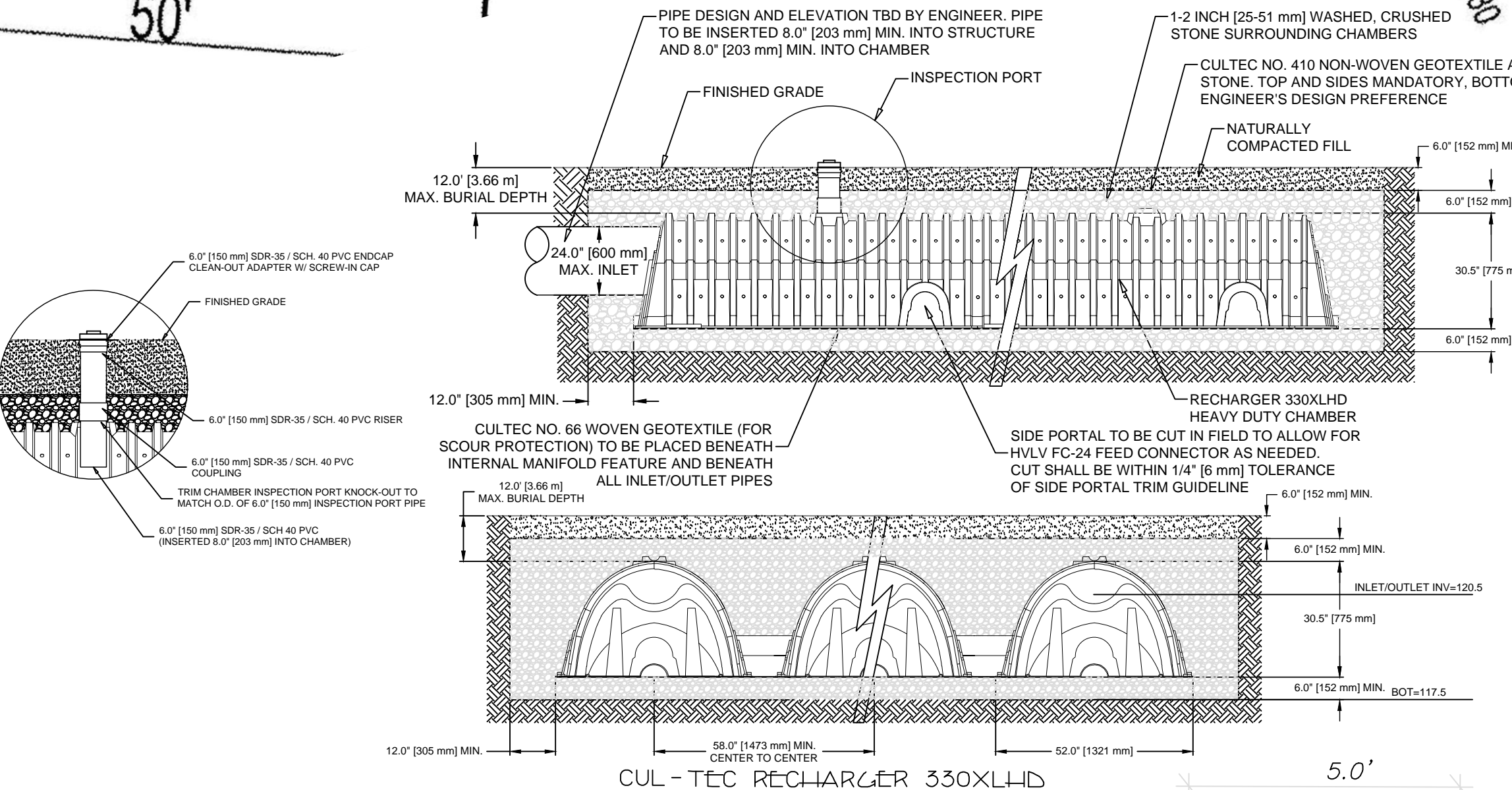
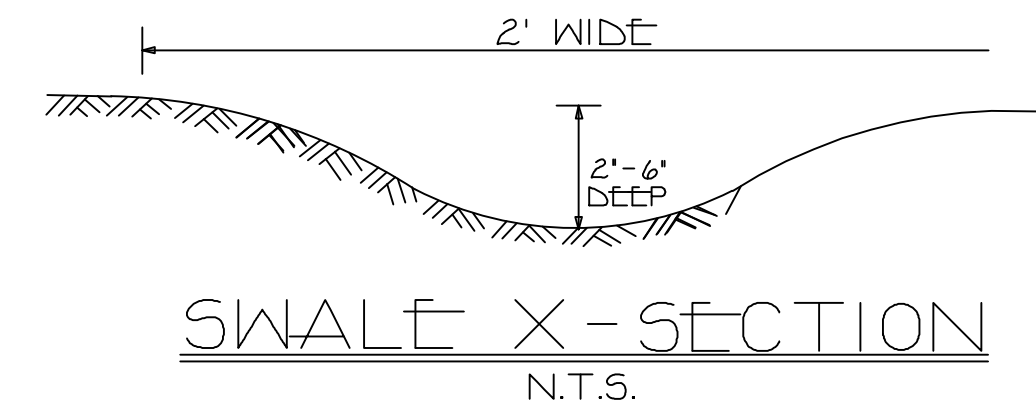

Recharger 330XLHD Chamber Specifications	
Height	30.5 inches
Width	52.0 inches
Length	8.50 feet
Installed Length	7.00 feet
Base Chamber Volume	92.21 cu. feet
Installed Chamber Volume	84.22 cu. feet

Breakdown of Storage Provided by Recharger 330XLHD Stormwater System	
Within Chambers	335.66 cu. feet
Within Feed Connectors	cu. feet
Within Stone	270.67 cu. feet
Total Storage Provided	606.33 cu. feet
Total Storage Required	472.00 cu. feet

Materials List	
Recharger 330XLHD	
Total Number of Chambers Required	6 pieces
Starter Chambers	2 pieces
Intermediate Chambers	2 pieces
End Chambers	2 pieces
HVLV FC-24 Feed Connectors	0 pieces
CULTEC No. 410 Non-Woven Geotextile	115 sq. yards
CULTEC No. 4000 Woven Geotextile	0 cu. yards
Stone	25 cu. yards

Bed Detail	
Number of Rows Wide	2 pieces
Number of Chambers Long	3 pieces
Chamber Row Width	9.67 feet
Chamber Row Length	22.50 feet
Bed Width	11.67 feet
Bed Length	24.50 feet
Bed Area Required	285.83 sq. feet
Length of Separator Row	N/A feet

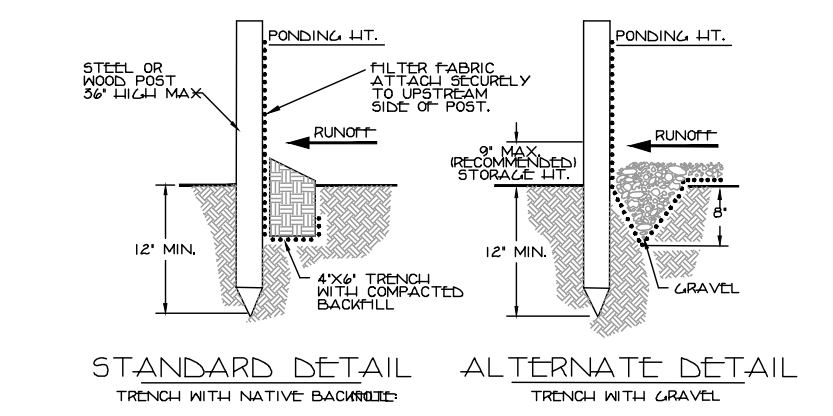
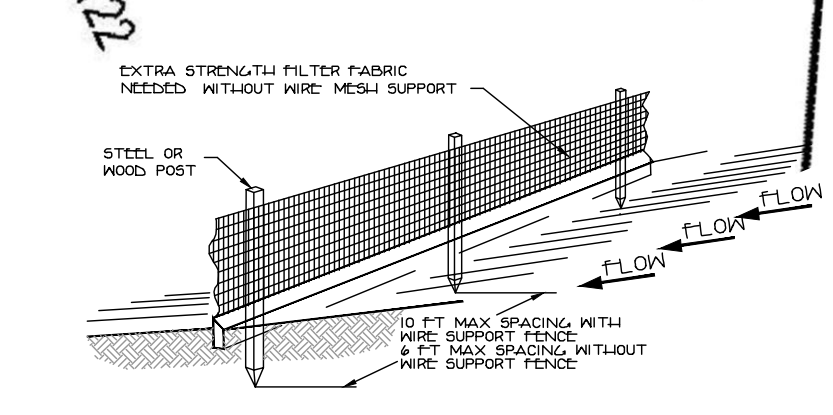

SILT FENCE
N.T.S.

UNAUTHORIZED ALTERATION OR ADDITION TO THIS PLAN IS A VIOLATION OF SECTION 720(2) OF THE NEW YORK STATE EDUCATION LAW. COPIES OF THIS MAP NOT HAVING THE SEAL OF THE SURVEYOR OR ENGINEER SHALL NOT BE VALID.
CERTIFICATIONS ARE NOT TRANSFERABLE TO ADDITIONAL INSTITUTIONS OR SUBSEQUENT OWNERS.
USE OF UNSEALED OR UNRECORDED THIS DOCUMENT IN ANY COURT, FINANCIAL TRANSACTION, OR FILING WITH ANY STATE, FEDERAL OR OFFICE IS AN UNLAWFUL VIOLATION OF FEDERAL COPYRIGHT LAWS.

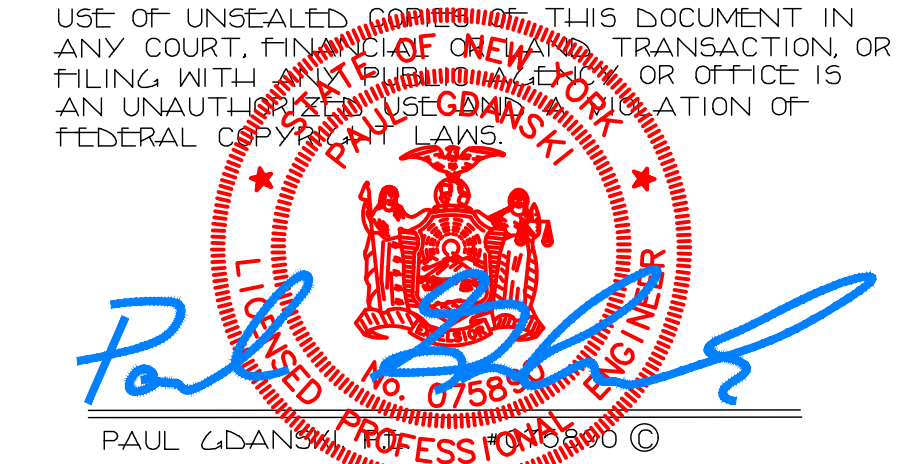
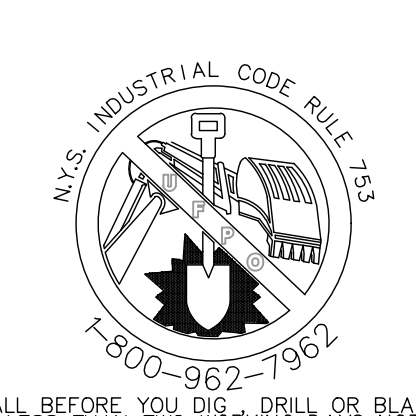

REVISIONS	
1	2/26/23 REVISE

DRAINAGE PLAN FOR ZAPATA
LOCATED IN THE HAMLET OF TAPPAN TOWN OF ORANGETOWN ROCKLAND COUNTY, NEW YORK

PAUL GDANSKI, PE, PLLC
633 WOODMONT LANE
SLOATSBURG, N.Y. 10974
TEL: (917) 418-0999

DATE	12/27/22
SCALE	1" = 10'
SHEET	1 OF 1

CULTEC UNIT MAINTENANCE NOTES
1. CULTEC UNITS SHALL BE MAINTAINED BY THE OWNERS OF THE LOTS ON WHICH THEY ARE SITED.
2. THE CONTRACTOR SHALL BE RESPONSIBLE FOR DETERMINING SEASONAL HIGH WATER TABLE. NO CULTEC UNIT AND/OR STONE SHALL BE SET BELOW SEASONAL HIGH WATER. THE CONTRACTOR AND ENGINEER MUST BE CONTACTED IN WRITING SHOULD WATER BE ENCOUNTERED.
3. PERCOLATION TEST REQUIRED.

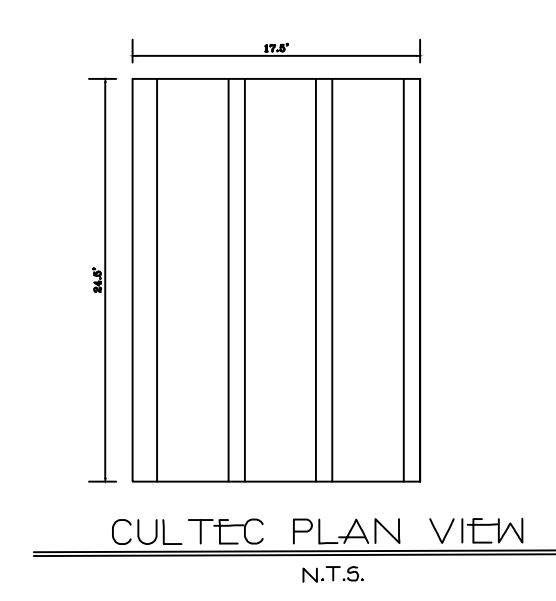
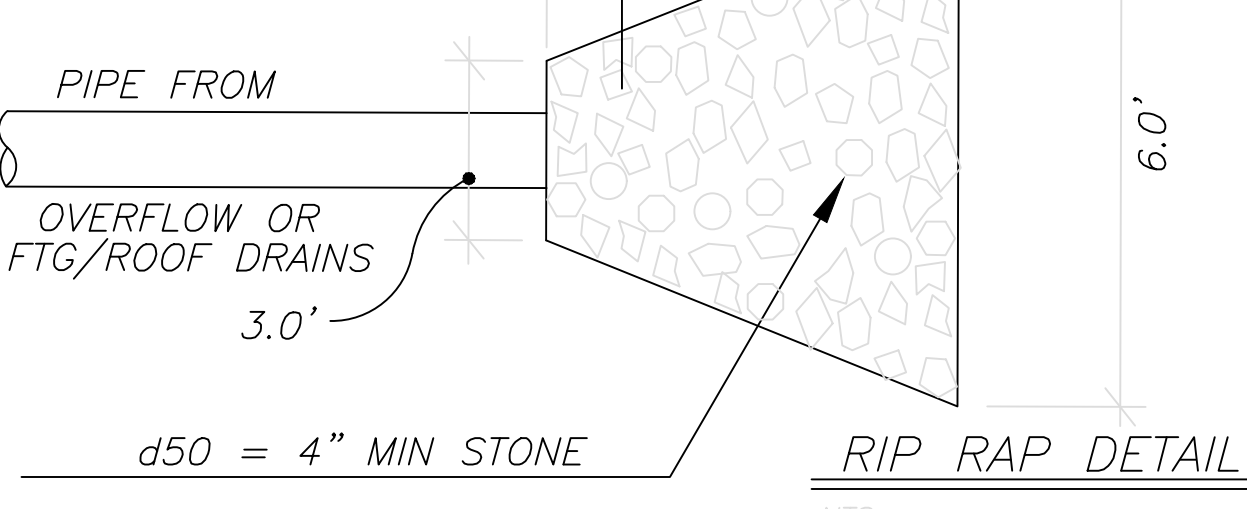

BEFORE YOU SIGN OR PRINT, NO LESS THAN TWO WORKDAYS NOTICE IT'S THE LAW!