

NOTES:

1. FOR LANDSCAPE PURPOSES ONLY.
2. SEE SHEET SD09.02 AND SHEET SD09.03 FOR FULL PLANT SCHEDULE, DETAILS, NOTES, AND SPECIFICATIONS.
3. TREES SHALL BE PLANTED MINIMUM DISTANCE OF 10' FROM UNDERGROUND UTILITIES.
4. BASE SITE INFORMATION PROVIDED BY: BROOKER ENGINEERING, PLLC.

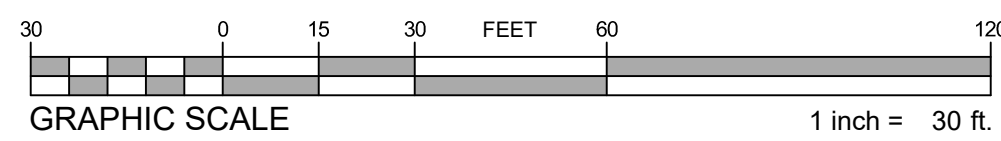

LANDSCAPE PLAN

GATTO LANE

TOWN OF ORANGETOWN, ROCKLAND COUNTY, NEW YORK

DATE: 11/23/22	SCALE: 1"=30'
DESIGN: ESE	DRAWN: ESE
JOB NO.: 7855	FILE NAME: 7855-LAND
SHEET NO.: 1	OF 3

DRAFT

Engineering
Surveying
Landscape
Architecture

CMG

CMG Engineering, Surveying and
Landscape Architecture, P.C.
42 Old Ridgebury Road
Danbury, CT 06810
Tel: (203) 616-9551
Fax: (203) 616-9550

PLANT SCHEDULE

TREES	QTY	BOTANICAL NAME	COMMON NAME	CONT	SIZE
AS	9	ACER SACCHARUM 'COMMEMORATION'	COMMEMORATION SUGAR MAPLE	B & B	2 1/2" CAL.
AC	12	AMELANCHIER CANADENSIS	CANADIAN SERVICEBERRY	B & B	7'-8" HT.
CR	9	CORNUS X 'RUTGAN'	STELLAR PINK® DOGWOOD	B & B	7'-8" HT.
GT	11	GLEDITSIA TRIACANTHOS INERMIS 'SHADEMASTER'	SHADEMASTER HONEY LOCUST	B & B	2 1/2" CAL.
MS	8	MALUS X 'SPRING SNOW'	SPRING SNOW CRABAPPLE	B & B	7'-8" HT.
NS	13	NYSSA SYLVATICA	BLACK GUM	B & B	2 1/2" CAL.
PR	5	PRUNUS SARGENTII	SARGENT CHERRY	B & B	2 1/2" CAL.
EVERGREEN TREES	QTY	BOTANICAL NAME	COMMON NAME	CONT	SIZE
JV	19	JUNIPERUS VIRGINIANA	EASTERN REDCEDAR	B & B	6'-8" HT.
PG	47	PICEA GLAUCA	WHITE SPRUCE	B & B	6' - 8" HT.
PP	11	PICEA PUNGENS 'GLAUCA'	BLUE COLORADO SPRUCE	B & B	6'-8" HT.
PF	40	PINUS STROBUS 'FASTIGIATA'	PYRAMIDAL WHITE PINE	B & B	6'-8" HT.
TD	8	THUJA OCCIDENTALIS 'DARK GREEN'	DARK AMERICAN ARBORVITAE	B & B	6'-8" HT.
TH	12	THUJA STANDISHII X PLICATA 'GREEN GIANT'	GREEN GIANT ARBORVITAE	B & B	7'-8" HT.
STREET TREES	QTY	BOTANICAL NAME	COMMON NAME	CONT	SIZE
AR	14	ACER RUBRUM 'AUTUMN FLAME'	AUTUMN FLAME RED MAPLE	B & B	2 1/2" CAL.
QP	21	QUERCUS PHELLOS	WILLOW OAK	B & B	2 1/2" CAL.
SHRUBS	QTY	BOTANICAL NAME	COMMON NAME	CONT	SIZE
BG	6	BUXUS X 'GREEN MOUNTAIN'	GREEN MOUNTAIN BOXWOOD	CONT.	30"-36" HT.
HJ	30	HYDRANGEA PANICULATA 'JANE'	LITTLE LIME® PANICLE HYDRANGEA	CONT.	3 GAL.
HQ	71	HYDRANGEA QUERCIFOLIA	OAKLEAF HYDRANGEA	CONT.	30"-36" HT.
IG	83	ILEX GLABRA 'CHAMZIN' TM	NORDIC HOLLY	3 GAL.	36" MIN HT.
IL	88	ITEA VIRGINICA 'LITTLE HENRY' TM	VIRGINIA SWEETSPIRE	2 GAL.	24" MIN HT.
PO	35	PRUNUS LAUROCERASUS 'OTTO LUYKEN'	OTTO LUYKEN ENGLISH LAUREL	CONT.	3 GAL.
VP	47	VIBURNUM PLICATUM 'POPCORN'	POPCORN JAPANESE SNOWBALL	CONT.	48" MIN. HT.
STORMWATER TREES	QTY	BOTANICAL NAME	COMMON NAME	CONT	SIZE
CO	3	CELTIS OCCIDENTALIS	COMMON HACKBERRY	B & B	2 1/2" CAL.
STORMWATER PLANTINGS	QTY	BOTANICAL NAME	COMMON NAME	CONT	SIZE
CE	53	CEPHALANTHUS OCCIDENTALIS 'SMCOSS'	SUGAR SHACK® BUTTONBUSH	CONT.	1 GAL
CA	62	CORNUS AMOMUM	SILKY DOGWOOD	CONT.	1 GAL
IC	93	ILEX GLABRA 'CHAMZIN'	NORDIC™ INKBERRY HOLLY	CONT.	1 GAL
IV	6	ILEX VERTICILLATA 'JIM DANDY'	JIM DANDY WINTERBERRY	CONT.	1 GAL
IB	29	ILEX VERTICILLATA 'SPRIBER'	BERRY NICE® WINTERBERRY	CONT.	1 GAL
RP	48	ROSA PALUSTRIS	SWAMP ROSE	CONT.	1 GAL

LANDSCAPE NOTES

- THE LANDSCAPE PLAN AND DETAIL SHEET ARE FOR LANDSCAPING INFORMATION ONLY. PLEASE REFER TO THE SITE LAYOUT PLAN, LIGHTING PLAN, GRADING PLAN AND UTILITIES PLAN FOR ALL OTHER INFORMATION.
- THE CONTRACTOR SHALL GUARANTEE THAT ALL PLANTS, TREES, AND SHRUBS SHALL BE HEALTHY AND FREE OF DISEASE FOR A PERIOD OF ONE YEAR AFTER SUBSTANTIAL COMPLETION AND ACCEPTANCE BY OWNER OR LANDSCAPE ARCHITECT. CONTRACTOR SHALL REPLACE ANY DEAD OR UNHEALTHY PLANTS AT CONTRACTOR'S EXPENSE. PLANT MATERIAL REPLACEMENTS SHALL BE GUARANTEED FOR ONE FULL YEAR FROM DATE OF REPLACEMENT. FINAL ACCEPTANCE SHALL BE MADE IF ALL PLANTS MEET THE GUARANTEE REQUIREMENTS INCLUDING MAINTENANCE. MAINTENANCE RESPONSIBILITIES INCLUDE CULTIVATING, SPRAYING, WEEDING, WATERING, TIGHTENING GUYS, PRUNING, FERTILIZING, MULCHING, AND ANY OTHER OPERATIONS NECESSARY TO MAINTAIN PLANT VIABILITY. MAINTENANCE SHALL BEGIN IMMEDIATELY AFTER PLANTING AND CONTINUE UNTIL THE END OF THE ONE YEAR GUARANTEE PERIOD.
- THE CONTRACTOR SHALL SUPPLY ALL LABOR, PLANTS, AND MATERIALS IN QUANTITIES SUFFICIENT TO COMPLETE THE WORK SHOWN ON THE DRAWINGS AND LISTED IN THE PLANT SCHEDULE. IN THE EVENT OF A DISCREPANCY BETWEEN QUANTITIES SHOWN IN THE PLANT SCHEDULE AND THOSE REQUIRED BY THE DRAWINGS, THE LARGER SHALL APPLY. ALL PLANTS SHALL BE ACCLIMATED BY THE SUPPLY NURSERY TO THE LOCAL HARDINESS ZONE AND BE CERTIFIED THAT THE PLANTING MATERIAL HAS BEEN GROWN FOR A MINIMUM OF TWO YEARS AT THE SOURCE AND OBTAINED WITHIN 200 MILES OF PROJECT SITE UNLESS OTHERWISE APPROVED BY OWNER OR LANDSCAPE ARCHITECT.
- THE LOCATIONS FOR PLANT MATERIAL ARE APPROXIMATE AND ARE SUBJECT TO FIELD ADJUSTMENT DUE TO SLOPE, VEGETATION, AND SITE FACTORS SUCH AS THE LOCATION OF ROCK OUTCROPS. PRIOR TO PLANTING THE CONTRACTOR SHALL ACCURATELY STAKE OUT THE LOCATIONS FOR ALL PLANTS. THE OWNER OR LANDSCAPE ARCHITECT SHALL APPROVE THE FIELD LOCATIONS OR ADJUSTMENTS OF THE PLANT MATERIAL.
- ALL SHRUB MASSINGS SHALL BE MULCHED TO A DEPTH OF 3". ANNUAL AND PERENNIAL BEDS SHALL BE MULCHED TO A DEPTH OF 2". SHREDDED HARDWOOD BARK MULCH SHALL BE SPREAD OVER GEOTEXTILE FABRIC EQUAL TO MAAPF MODEL 1-40 NL FOR SHRUB MASSING AREAS, ANNUAL AND PERENNIAL FLOWER BEDS. INSTALL PER MANUFACTURER'S RECOMMENDATIONS. GROUND COVER AREAS SHALL NOT HAVE FABRIC.
- NO PLANT SHALL BE PLACED IN THE GROUND BEFORE ROUGH GRADING HAS BEEN COMPLETED AND APPROVED BY LANDSCAPE CONTRACTOR. STAKING THE LOCATION OF ALL TREES AND SHRUBS SHALL BE COMPLETED PRIOR TO PLANTING FOR APPROVAL BY THE OWNER OR LANDSCAPE ARCHITECT. STAKING OF THE INSTALLED TREE MUST BE COMPLETED THE SAME DAY AS IT IS INSTALLED. ALL TREES SHALL BE STAKED OR GUYED PER DETAIL. SEE LANDSCAPE DETAIL SHEET FOR PLANTING DETAILS.
- COORDINATE PLANT MATERIAL LOCATIONS WITH SITE UTILITIES. SEE SITE LAYOUT, GRADING AND UTILITY FOR STORM, SANITARY AND WATER LINES. SEE LIGHTING PLAN FOR ELECTRICAL AND LIGHTING LAYOUT AND DETAILS. UTILITY LOCATIONS ARE APPROXIMATE. EXERCISE CARE WHEN DIGGING IN AREAS OF POTENTIAL CONFLICT WITH UNDERGROUND OR OVERHEAD UTILITIES. THE CONTRACTOR IS RESPONSIBLE FOR ANY DAMAGE DUE TO CONTRACTOR'S NEGLIGENCE AND SHALL REPLACE OR REPAIR ANY DAMAGE AT CONTRACTOR'S EXPENSE.
- LANDSCAPE PLANTING PITS MUST BE FREE DRAINING, PAVEMENT, COMPACTED SUBGRADE, AND BLASTED ROCK SHALL BE REMOVED FROM WITHIN ISLANDS TO BE LANDSCAPED TO A DEPTH OF 2' OR TO A GREATER DEPTH IF REQUIRED BY PLANTING DETAILS OR SPECIFICATIONS. REPLACE SOIL WITHIN ISLANDS WITH MODERATELY COMPACTED LOAM OR SANDY LOAM FREE FROM STONES AND RUBBISH 1" OR GREATER IN DIAMETER AND ANY OTHER MATERIAL HARMFUL TO PLANT GROWTH AND DEVELOPMENT. PLANTING INSTALLATION WITHIN ISLANDS SHALL BE AS DETAILED AND CONTAIN PLANTING MIX AS SPECIFIED.
- PLANTING SOIL MIXTURE:
2 PARTS PEAT MOSS
5 PARTS TOPSOIL
MYCORHIZA INOCULANT - "TRANSPLANT 1-STEP" AS MANUFACTURED BY ROOTS, INC. OR APPROVED EQUAL. USE PER MANUFACTURER'S RECOMMENDATIONS FOR TREES AND SHRUBS. FERTILIZER/LIME APPLY AS RECOMMENDED BY SOIL ANALYSIS
- TREES AND SHRUBS: TREES AND SHRUBS SHALL BE NURSERY GROWN UNLESS OTHERWISE NOTED AND HARDY UNDER CLIMATIC CONDITIONS SIMILAR TO THOSE IN THE LOCATION OF THE PROJECT. THEY SHALL BE TYPICAL OF THEIR SPECIES OR VARIETY, WITH NORMAL HABIT OF GROWTH. THEY SHALL BE SOUND, HEALTHY, VIGOROUS, WELL-BRANCHED AND DENSELY FOLIATED WHEN IN LEAF. THEY SHALL BE FREE OF DISEASE, INSECT PESTS, EGGS OR LARVAE. THEY SHALL HAVE HEALTHY AND WELL-DEVELOPED ROOT SYSTEMS. ALL TREES SHALL HAVE STRAIGHT SINGLE TRUNKS WITH THEIR MAIN LEADER INTACT UNLESS OTHERWISE STATED. THE OWNER OR LANDSCAPE ARCHITECT SHALL ONLY PERMIT SUBSTITUTIONS UPON WRITTEN APPROVAL. THEIR SIZES SHALL CONFORM TO THE MEASUREMENT SPECIFIED ON THE DRAWINGS. PLANTS LARGER THAN SPECIFIED ON THE DRAWINGS MAY BE USED IF APPROVED. THE USE OF SUCH PLANTS SHALL NOT INCREASE THE CONTRACT PRICE. ALL OVERSTORY TREES PLANTED ALONG PARKING AREAS, SIDEWALKS AND PEDESTRIAN ACCESSES SHALL HAVE SINGLE STRAIGHT TRUNKS AND SHALL NOT BRANCH BELOW 7' FEET HIGH.
- ANNUALS, PERENNIALS, AND GROUNDCOVERS: ALL PLANT MATERIALS ARE SUBJECT TO INSPECTION AND ACCEPTANCE BY THE OWNER OR LANDSCAPE ARCHITECT AT THE NURSERY SOURCE OR PLACE OF GROWTH. THE CONTRACTOR SHALL COORDINATE WITH THE LANDSCAPE ARCHITECT ON A SCHEDULE FOR SOURCE VISITS AND ACCOMPANY THE OWNER OR LANDSCAPE ARCHITECT FOR ALL SOURCE INSPECTIONS. CERTIFICATES OF COMPLIANCE IS REQUIRED FOR ALL PLANT MATERIALS.
- ALL SLOPES GREATER THAN 3:1 RECEIVING A GRASS SEEDING MIXTURE SHALL BE COVERED WITH AN EROSION CONTROL BLANKET.
- TOPSOIL SHALL BE INSTALLED AT A MINIMUM DEPTH OF 4". CONTRACTOR SHALL SUBMIT TOPSOIL TO A CERTIFIED TESTING LABORATORY TO DETERMINE pH, FERTILITY, ORGANIC CONTENT AND MECHANICAL COMPOSITION. THE CONTRACTOR SHALL SUBMIT THE TEST RESULTS FROM REGIONAL EXTENSION OFFICE OF USDA TO THE OWNER OR LANDSCAPE ARCHITECT FOR REVIEW AND APPROVAL. CONTRACTOR SHALL INCORPORATE AMENDMENTS FOR GOOD PLANT GROWTH AND PROPER SOIL ACIDITY RECOMMENDED FROM THE TOPSOIL TEST.
- UNLESS OTHERWISE NOTED IN DRAWING SET, NEW TREELINES SHALL EQUAL CLEARING AND GRUBBING LIMIT FOR CONSTRUCTION.

SEED MIXES

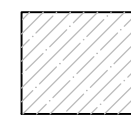

Basin Side Slope Seed Mix
EROT SEED MIX - 18000/1.56 (OR APPROVED EQUAL)

Mix Composition
73.2% Festuca ovina, Variety Not Stated (Sheep Fescue, Variety Not Stated)
17.0% Lolium multiflorum (Annual Ryegrass)
3.0% Chrysanthemum maximum (Shasta Daisy)
2.0% Coreopsis lanceolata (Lanceleaf Coreopsis)
2.0% Rudbeckia hirta, Coastal Plain NC Ecotype (Blackeyed Susan, Coastal Plain NC Ecotype)
0.5% Achillea millefolium (Common Yarrow)
0.5% Asclepias tuberosa (Butterfly Milkweed)
0.3% Chamaecrista fasciculata, PA Ecotype (Partridge Pea, PA Ecotype)
0.3% Eupatorium coelestinum, VA Ecotype (Mistflower, VA Ecotype)
0.3% Rudbeckia fulgida var. fulgida, Northern VA Ecotype (Orange Coneflower, Northern VA Ecotype)
0.2% Penstemon hirsutus (Hairy Beardtongue)
0.2% Pycnanthemum tenuifolium (Narrowleaf Mountainmint)
0.1% Aster oblongifolius, PA Ecotype (Aromatic Aster, PA Ecotype)
0.1% Aster prenanthoides, PA Ecotype (Zigzag Aster, PA Ecotype)
0.1% Baptisia tinctoria, PA Ecotype (Yellow False Indigo (Horseflyweed), PA Ecotype)
0.1% Tradescantia virginiana, Southeastern PA/Northern VA blend (Virginia Spiderwort, Southeastern PA/Northern VA blend)

SEEDING RATE: 20-40 LB PER ACRE OR 1 POUND PER 1,000 SQ.FT.

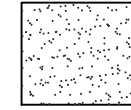

Basin Floor Seed Mix - Low Maintenance
EROT SEED MIX - 18000/1.56 (OR APPROVED EQUAL)

Mix Composition
20.0% Puccinellia distans, 'Fulfs' (Alkaligrass, 'Fulfs')
19.0% Panicum clandestinum, 'Tioga' (Deertongue, 'Tioga')
18.0% Agrostis stolonifera (Creeping Bentgrass)
18.0% Elymus virginicus, PA Ecotype (Virginia Wildrye, PA Ecotype)
15.0% Poa palustris (Fowl Bluegrass)
3.0% Juncus effusus (Soft Rush)
2.0% Carex scoparia, PA Ecotype (Blunt Broom Sedge, PA Ecotype)

HEIGHT: 0.35-0 FT
SEEDING RATE: 20-40 LB PER ACRE OR 1 POUND PER 1,000 SQ.FT.

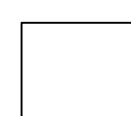

General Seed Mix

Mix Composition
60.0% Kentucky Bluegrass
10.0% Pennine Perennial Ryegrass
30.0% Pennlawn Fescue

SEEDING RATE: 4 LB PER 1,000 SQ.FT.

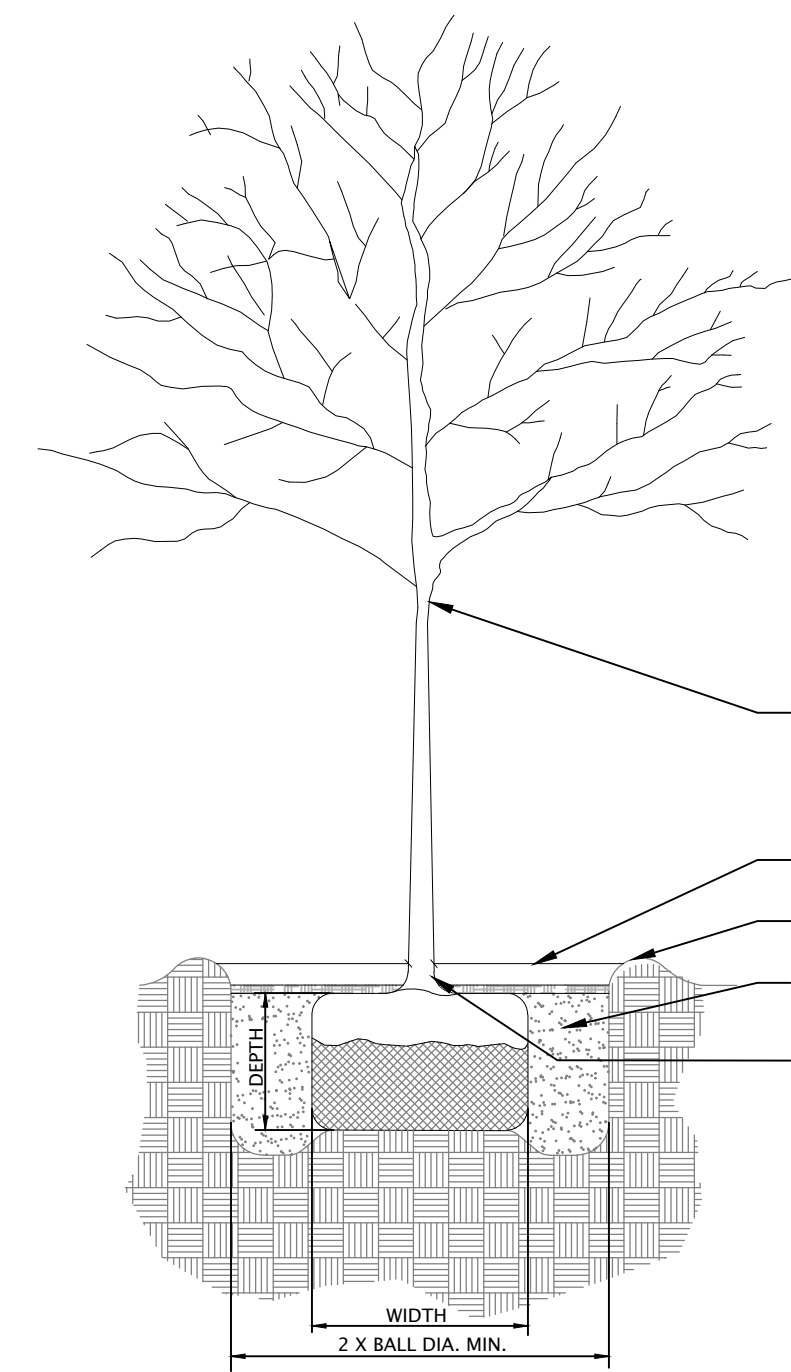

DO NOT CUT CENTRAL LEADER. TREES WITH DAMAGED/CUT/BROKEN CENTRAL LEADERS WILL BE REJECTED. ALL DAMAGED BRANCHES TO BE REMOVED.

3" MULCH WITH NO MULCH AGAINST TRUNK

3" EARTH SAUCER

BACKFILL MIXTURE: 1 PART TOPSOIL, 1 PART PEAT MOSS, 1 PART COURSE SAND

REMOVE BURLAP FROM TOP 1/3 OF BALL. NO BURLAP SHALL BE SEEN ABOVE SOIL LINE. ROPE & TWINE TO BE REMOVED FROM PIT. CUT WIRE BASKET IN 4 PLACES, FOLD DOWN 8" INTO HOLE. TOP OF BALL TO BE LEVEL WITH GRADE. ROOT FLARE EXPOSED.

NOTE:
1. THE DEPTH OF ROOTBALL SHALL BE NO LESS THAN 60% ITS WIDTH

TREE PLANTING
NOT TO SCALE

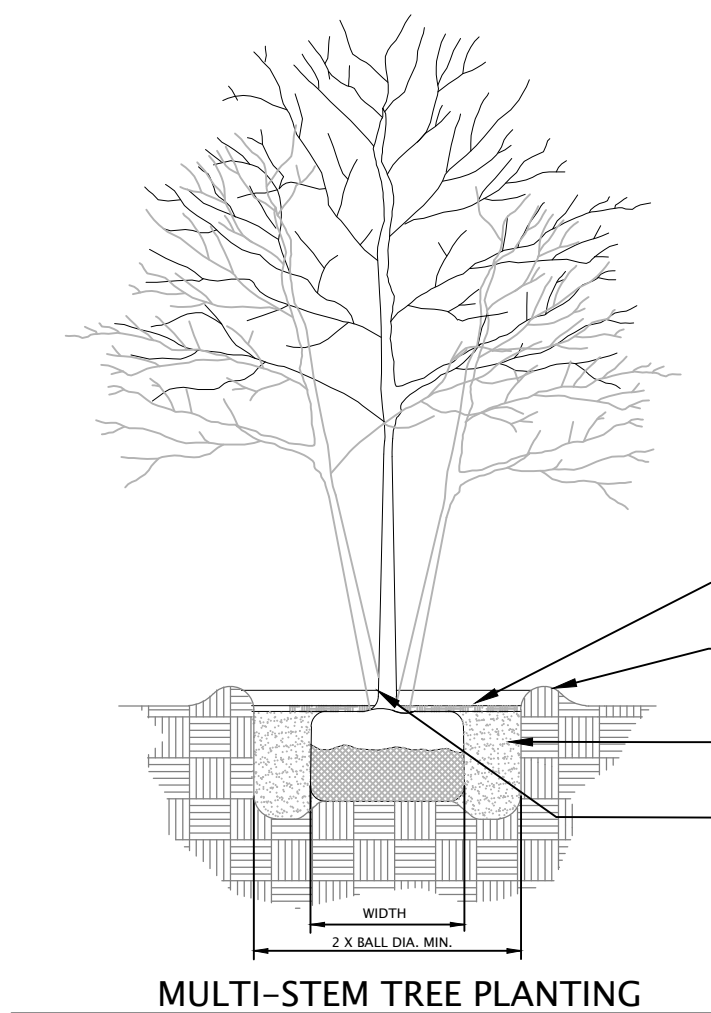

3" MULCH WITH NO MULCH AGAINST TRUNK

3" EARTH SAUCER

BACKFILL MIXTURE: 1 PART TOPSOIL, 1 PART PEAT MOSS, 1 PART COURSE SAND

REMOVE BURLAP FROM TOP 1/3 OF BASE TOP OF BALL TO BE LEVEL WITH GRADE

NOTE:
1. THE DEPTH OF ROOTBALL SHALL BE NO LESS THAN 60% ITS WIDTH

MULTI-STEM TREE PLANTING
NOT TO SCALE

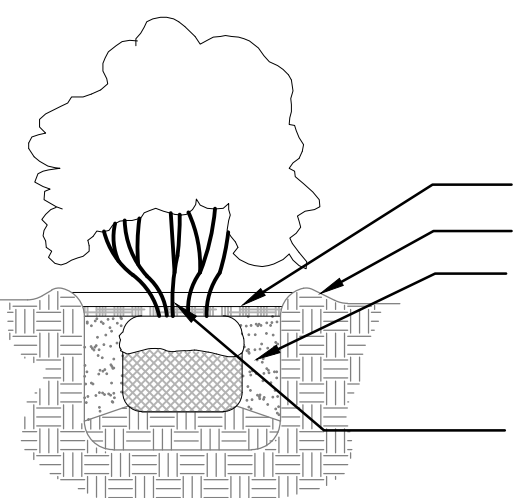

MULCH AS SPECIFIED

3" EARTH SAUCER

BACKFILL MIXTURE: 2 PARTS NATIVE SOIL, 1 PART TOP SOIL, 1 PART PEAT MOSS

REMOVE BURLAP FROM TOP 1/3 OF BASE. TOP OF BALL TO BE LEVEL WITH GRADE

NOTE:
SHRUB ROOTBALLS SHALL BE TYPICALLY 12" WIDE. THE DEPTH OF THE ROOTBALL SHALL BE NO LESS THAN 65% ITS WIDTH.

SHRUB PLANTING
NOT TO SCALE

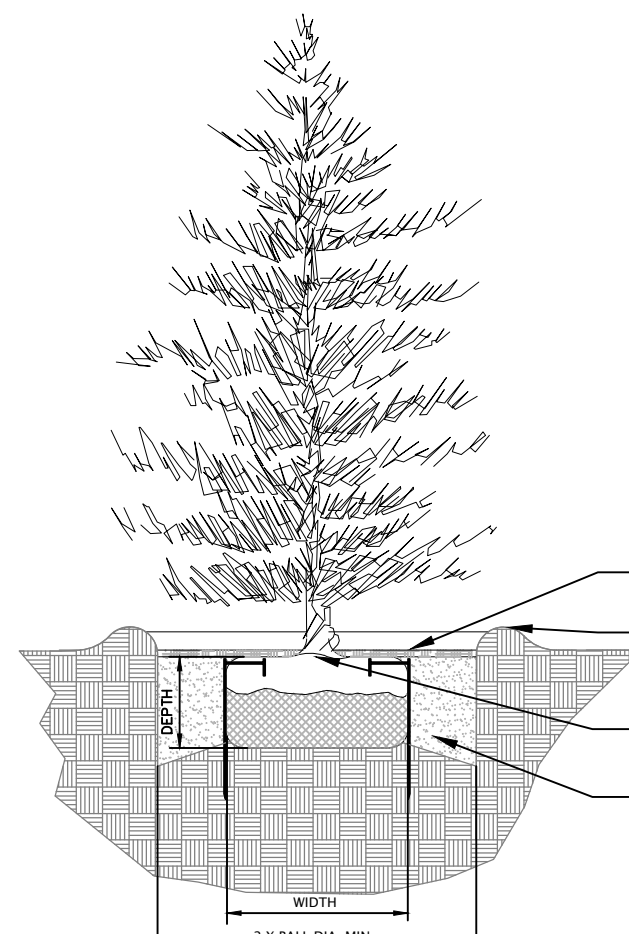

MULCH AS SPECIFIED

3" EARTH SAUCER

REMOVE BURLAP FROM TOP 1/3 OF BASE TOP OF BALL TO BE LEVEL WITH GRADE

BACKFILL MIXTURE: 1 PART TOPSOIL, 1 PART PEAT MOSS, 1 PART COURSE SAND

NOTE:
1. THE DEPTH OF ROOTBALL SHALL BE NO LESS THAN 60% ITS WIDTH

CONIFER PLANTING
NOT TO SCALE

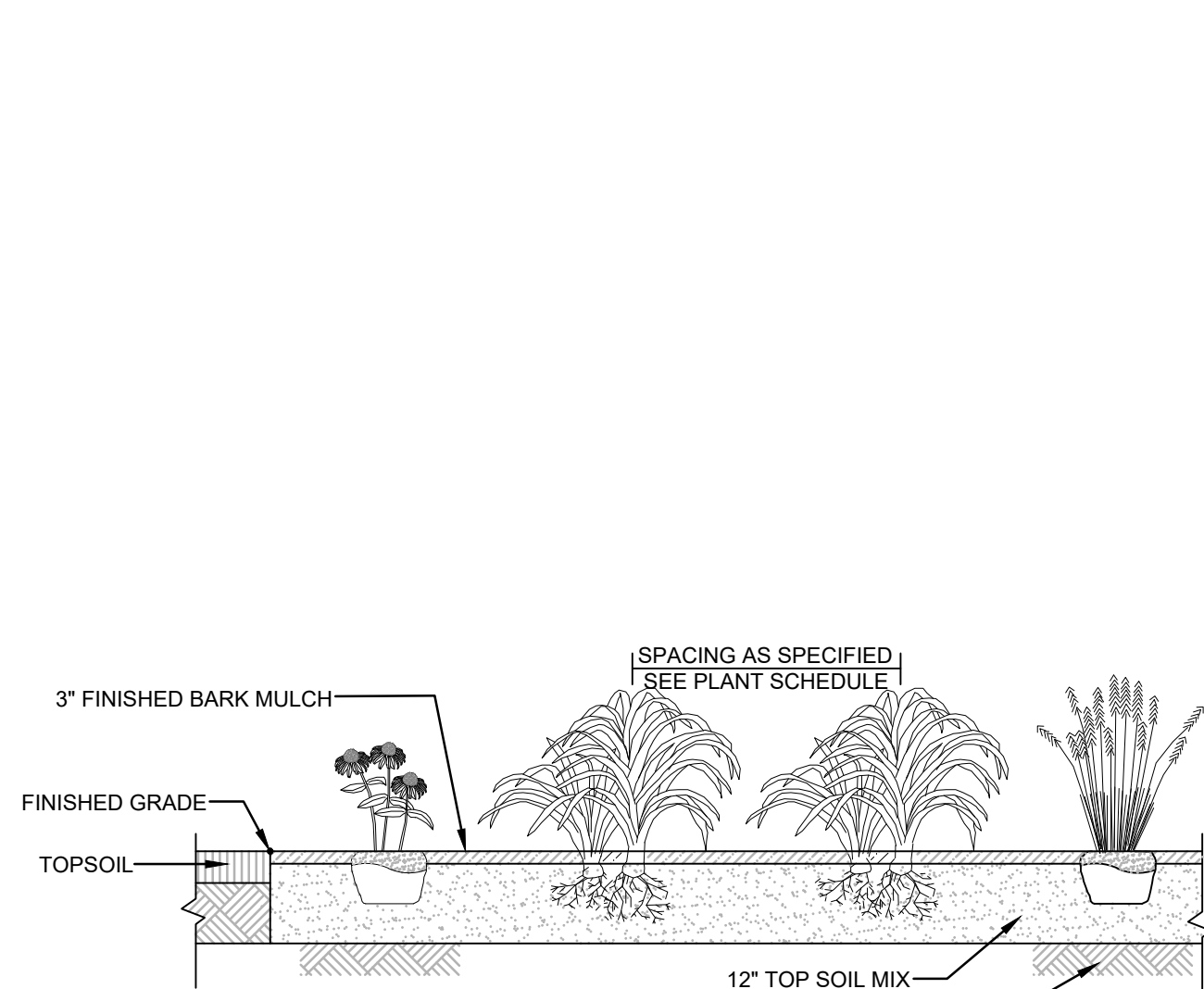

ANNUAL /PERENNIAL/GRASSES/GROUNDCOVER BEDS
NOT TO SCALE



PRODUCT INFORMATION:

Chair Manufacturer: Polywood
Chair Type: Nautical Curveback Adirondack
Color: Mahogany

Quantity: 4

Contact Information:
Website: www.polywood.com
Telephone: 1-855-935-5550

(or approved equal)

ADIRONDACK CHAIR
NOT TO SCALE



PRODUCT INFORMATION:

Bench Manufacturer: Polywood
Bench Type: Vineyard 60"
Color: Mahogany

Quantity: 2

Contact Information:
Website: www.polywood.com
Telephone: 1-855-935-5550

(or approved equal)

BENCH
NOT TO SCALE



PRODUCT INFORMATION:

Mailbox Unit Information: Cluster Box Unit with 12 Doors and 1 parcel Locker with USPS access - Type II

Mailbox Unit Manufacturer: Salisbury Industries
Model Information: #3312BLK-U
Dimensions: 30.5" W x 62" W x 18" D
Color: Black

Quantity: 3

Contact Information:
Website: www.mailboxes.com
Telephone: 1-800-624-5269

(or approved equal)

MAILBOX CLUSTER UNIT
NOT TO SCALE



PRODUCT INFORMATION:

Pavilion Manufacturer: Country Lane Gazebo
Pavilion Style: White Traditional Vinyl Pavilion with 8"x8" Posts
Size: 8' X 16'
Roof: Standing Seam Metal, Color Black

Quantity: 1

Contact Information:
Website: www.gazebo.com
Telephone: 1-877-429-3262

(or approved equal)

NOTE: SHOP DRAWINGS ARE TO BE PROVIDED BY THE MANUFACTURER

MAILBOX KIOSK STRUCTURE
NOT TO SCALE

LANDSCAPE NOTES & DETAILS

GATTO LANE
TOWN OF ORANGETOWN, ROCKLAND COUNTY, NEW YORK

DATE: 11/23/22	SCALE: AS NOTED
DESIGN: ESE	DRAWN:
JOB NO.: 7855	FILE NAME: 7855-D-LAND
REF. NO.:	
SHEET NO.: 2	OF 3

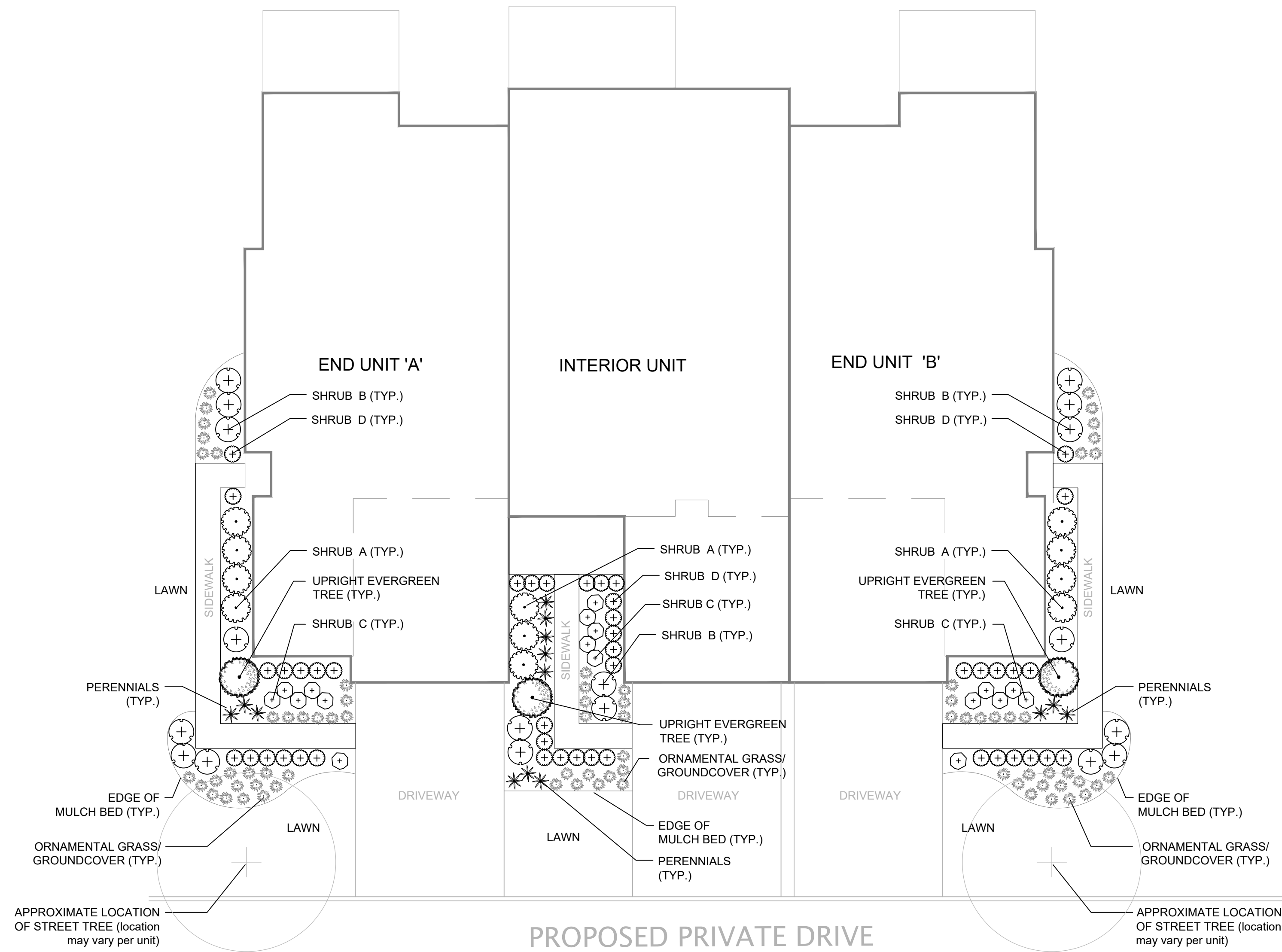

END UNIT 'A' - TYPICAL UNIT PLANT QUANTITIES

- (1) UPRIGHT EVERGREEN
- (4) SHRUB A - MEDIUM EVERGREEN SHRUB
- (7) SHRUB B - MEDIUM DECIDUOUS SHRUB
- (6) SHRUB C - SMALL DECIDUOUS
- (13) SHRUB D - EVERGREEN SHRUB
- (3) PERENNIALS
- (28) LOW ORNAMENTAL GRASSES OR GROUNDCOVER

INTERIOR UNIT - TYPICAL UNIT PLANT QUANTITIES

- (1) UPRIGHT EVERGREEN
- (3) SHRUB A - MEDIUM EVERGREEN SHRUB
- (1) SHRUB B - MEDIUM DECIDUOUS SHRUB
- (4) SHRUB C - SMALL DECIDUOUS
- (18) SHRUB D - EVERGREEN SHRUB
- (8) PERENNIALS
- (16) LOW ORNAMENTAL GRASSES OR GROUNDCOVER

END UNIT 'B' - TYPICAL UNIT PLANT QUANTITIES

- (1) UPRIGHT EVERGREEN
- (4) SHRUB A - MEDIUM EVERGREEN SHRUB
- (7) SHRUB B - MEDIUM DECIDUOUS SHRUB
- (6) SHRUB C - SMALL DECIDUOUS
- (13) SHRUB D - EVERGREEN SHRUB
- (3) PERENNIALS
- (28) LOW ORNAMENTAL GRASSES OR GROUNDCOVER

3-UNIT TYPICAL FOUNDATION PLANTING

SCALE: 1" = 10'

GATTO LANE - TYPICAL UNIT LANDSCAPE - PLANT LIST

Symbol	Upright Evergreen Tree - 4'-5' Ht.	
	<i>Ilex 'Dragon Lady'</i>	Dragon Lady Holly
	<i>Picea abies 'Cupressina'</i>	Columnar Norway Spruce
	<i>Picea pungens 'Glauca Fastigiata'</i>	Columnar Blue Spruce
	<i>Thuja occidentalis 'Smaragd'</i>	Emerald Green Arborvitae

Symbol	Shrub A - Medium Evergreen - 3 Gal.	
	<i>Ilex x meservae 'Blue Princess'</i> *plant with 1 male for berries	Blue Princess' Holly (Female)
	<i>Ilex x meservae 'Blue Prince'</i> *1 needed as pollinator	Blue Prince' Holly (Male)
	<i>Prunus laurocerasus 'Otto Luyken'</i>	Otto Luyken Cherry Laurel
	<i>Rhododendron x 'PJM'</i>	PJM Rhododendron
	<i>Taxus x media 'Hatfield'</i>	Hatfield Upright Yew

Symbol	Shrub B - Medium Deciduous - 3 Gal.	
	<i>Hydrangea arborescens 'Invincibelle Ruby'</i>	Invincibelle Ruby Hydrangea
	<i>Hydrangea paniculata 'Little Lime'</i>	Little Lime Hydrangea
	<i>Itea virginica 'Little Henry'</i>	Little Henry Sweetspire
	<i>Rosa rugosa 'Radtko'</i> or 'Sunny Knockout'	Pink or Yellow Flowering Knock Out Rose
	<i>Physocarpus opulifolius 'Summer Wine'</i> or 'Coppertina'	Ninebark cultivar
	<i>Weigela 'Wine and Roses'</i>	Wine and Roses Weigela

Symbol	Shrub C - Small Deciduous 30" Min. Ht.	
	<i>Spiraea 'Goldmound'</i> or 'Little Princess'	Dwarf Spiraea
	<i>Fothergilla gardenii</i>	Dwarf Fothergilla
	<i>Hydrangea 'Tiny Tuff Stuff'</i>	Tiny Tuff Stuff Hydrangea
	<i>Weigela 'Spilled Wine'</i>	Spilled Wine Weigela

Symbol	Shrub D - Small Evergreen 30" Min. Ht.	
	<i>Azalea 'Encore Autumn Cheer'</i>	Autumn Cheer Encore Azalea
	<i>Buxus microphylla var. japonica 'Green Beauty'</i>	Green Beauty Boxwood
	<i>Buxus 'Green Mountain'</i> (Pyramidal Form)	Green Mountain Boxwood
	<i>Ilex crenata 'Soft Touch'</i>	Soft Touch Japanese Holly
	<i>Thuja occidentalis 'Hetz Midget'</i>	Hetz Midget Arborvitae

Symbol	Perennials - 2 Gal.	
	Sun/ Part Shade	
	<i>Alchemilla mollis</i>	Lady's Mantle
	<i>Coreopsis verticillata 'Moonbeam'</i>	Moonbeam Threadleaf Coreopsis
	<i>Hemerocallis 'Stella de Oro'</i> or 'Purple de Oro'	Dwarf Reblooming Daylily
	<i>Leucanthemum superbum 'Snow Cap'</i>	Snow Cap Shasta Daisy
	<i>Nepeta racemosa 'Little Trudy'</i> or 'Walker's Low'	Walker's Low or Little Trudy Catmint
	<i>Rudbeckia fulgida var. sullivanti 'Little Goldstar'</i>	Little Goldstar Black-eyed Susan
	<i>Sedum 'Black Beauty'</i>	Black Beauty Sedum
	Part Shade/ Full Shade	
	<i>Astilbe arendsii 'Federsee'</i> or 'Amethyst'	Federsee or Amethyst Astilbe
	<i>Bergenia cordifolia</i>	Heartleaf Bergenia
	<i>Geranium macrorrhizum 'Bevans Variety'</i>	Bevan's Variety' Cranesbill
	<i>Heuchera x 'Plum Pudding'</i>	Plum Pudding Coral Bells
	<i>Hosta varieties</i>	Hosta

Symbol	Ornamental Grasses - 1 Gal./ Groundcover - 1 Gal.	
	Sun/ Part Shade	
	<i>Pennisetum alopecuroides 'Hameln'</i> or 'Piglet'	Dwarf Fountain Grass
	<i>Dianthus gratianopolitanus 'Bath's Pink'</i>	Baths Pink Dianthus
	<i>Festuca glauca 'Elijah Blue'</i> or 'Beyond Blue'	Blue Fescue
	<i>Liriope muscari 'Big Blue'</i> or 'Variegata'	Lilyturf
	<i>Phlox subulata</i>	Creeping Phlox
	<i>Sedum x 'Vera Jameson'</i>	Vera Jameson Sedum
	Part Shade/ Full Shade	
	<i>Hakonechloa macra 'Aureola'</i>	Golden Hakone Grass
	<i>Liriope muscari 'Big Blue'</i> or 'Variegata'	Lilyturf
	<i>Phlox stolonifera 'Sherwood Purple'</i>	Sherwood Purple' Creeping Phlox
	<i>Tiarella 'Sugar and Spice'</i>	Sugar and Spice Tiarella

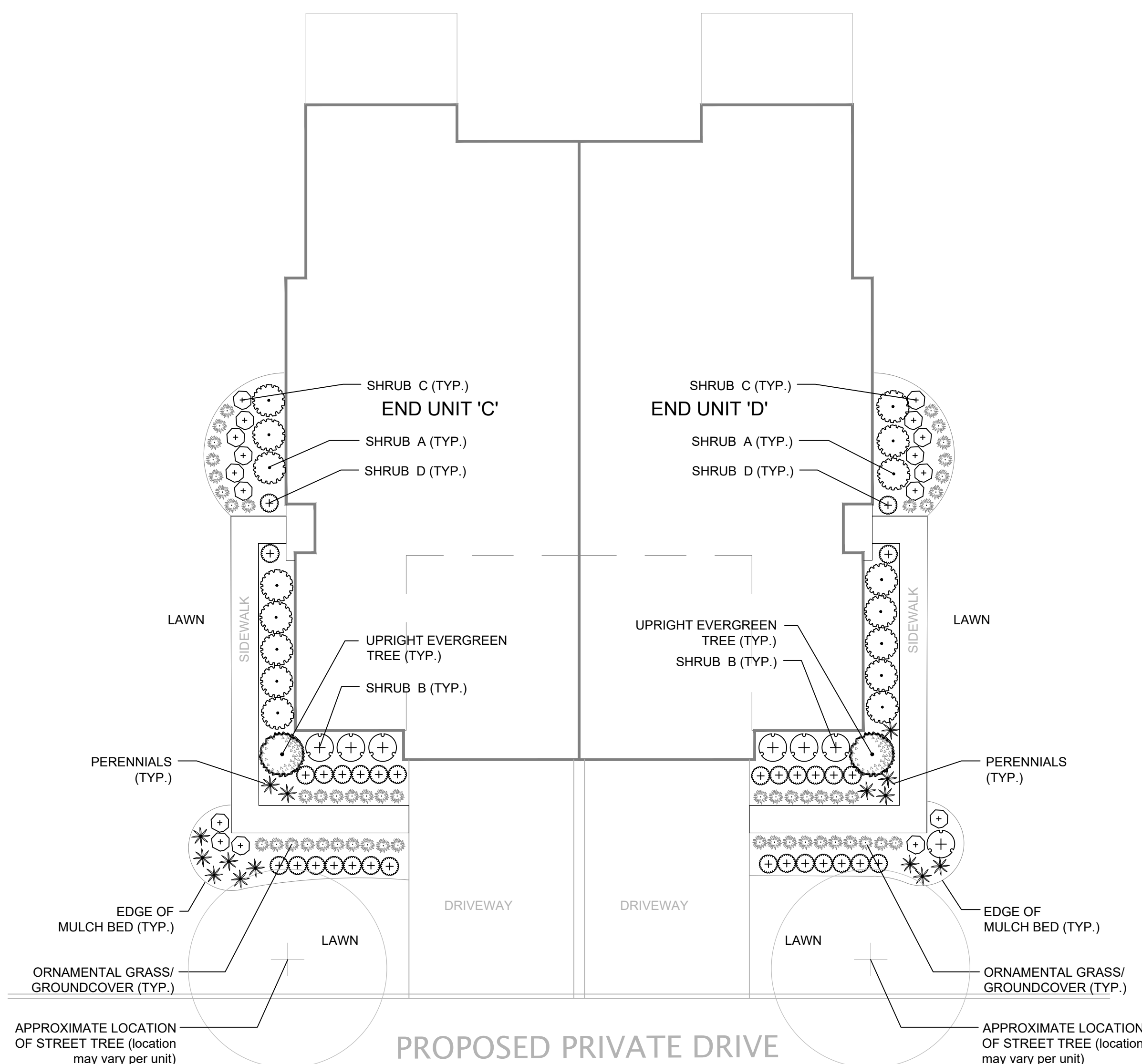

END UNIT 'C' - TYPICAL UNIT PLANT QUANTITIES

- (1) UPRIGHT EVERGREEN
- (8) SHRUB A - MEDIUM EVERGREEN SHRUB
- (3) SHRUB B - MEDIUM DECIDUOUS SHRUB
- (9) SHRUB C - SMALL DECIDUOUS
- (15) SHRUB D - EVERGREEN SHRUB
- (8) PERENNIALS
- (25) LOW ORNAMENTAL GRASSES OR GROUNDCOVER

END UNIT 'D' - TYPICAL UNIT PLANT QUANTITIES

- (1) UPRIGHT EVERGREEN
- (8) SHRUB A - MEDIUM EVERGREEN SHRUB
- (4) SHRUB B - MEDIUM DECIDUOUS SHRUB
- (8) SHRUB C - SMALL DECIDUOUS
- (15) SHRUB D - EVERGREEN SHRUB
- (6) PERENNIALS
- (25) LOW ORNAMENTAL GRASSES OR GROUNDCOVER

2-UNIT TYPICAL FOUNDATION PLANTING

SCALE: 1" = 10'

PLANT LEGEND

- UPRIGHT EVERGREEN
- SHRUB A - MEDIUM EVERGREEN SHRUB
- SHRUB B - MEDIUM DECIDUOUS SHRUB
- SHRUB C - SMALL DECIDUOUS
- SHRUB D - SMALL EVERGREEN SHRUB
- PERENNIALS
- ORNAMENTAL GRASSES / GROUNDCOVERS

TYPICAL UNIT PLANTING NOTES:

- LAYOUT OF PLANTING BED IS CONCEPTUAL AND MAY VARY DUE TO EXISTING SITE CONDITIONS AND MODEL ELEVATION. SPECIES CHOSEN SHALL CORRELATE WITH EXISTING SITE CONDITIONS OF EACH HOME (IE. SUN/ SHADE) TO ENSURE SURVIVABILITY OF PLANT.
- SHRUBS SHALL BE PLANTED IN GROUPS OF THE SAME SPECIES (3-5 PLANTS) TO MAINTAIN BALANCE THROUGHOUT THE GARDEN.
- FOUNDATION PLANTS ARE IN ADDITION TO AND ARE TO BE COORDINATED WITH PROPOSED STREET TREES, OPEN SPACE PLANTINGS AND EXISTING VEGETATION TO REMAIN.
- QUALITY OF PLANT SHALL BE IN ACCORDANCE WITH THE AMERICAN STANDARDS FOR NURSERY STOCK.
- SUBSTITUTIONS PERMITTED WITH WRITTEN APPROVAL BY ESE LANDSCAPE ARCHITECT AND TOWN REPRESENTATIVE PRIOR TO PLANTING.

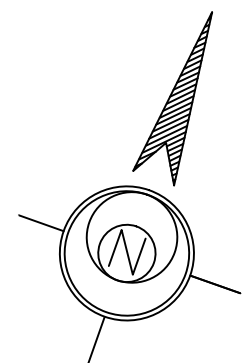
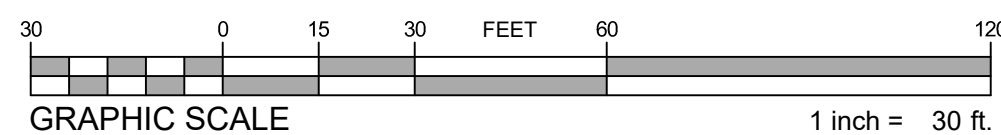

LANDSCAPE NOTES & DETAILS

GATTO LANE
TOWN OF ORANGETOWN, ROCKLAND COUNTY, NEW YORK

DATE: 11/23/22	SCALE: AS NOTED
DESIGN: ESE	DRAWN: ESE
JOB NO.: 7855	FILE NAME: 7855-P-LAND
REF. NO.:	
SHEET NO.: 3	OF 3

CMG Engineering, Surveying and
Landscape Architecture, P.C.
42 Old Ridgebury Road
Danbury, CT 06810
Tel: (203) 616-9951
Fax: (203) 616-9950

Engineering
Surveying
Landscape
Architecture

CMG

DRAFT