

FIELDWORK COMPLETED: JANUARY 26, 2022  
AUGUST 4, 2022

FILED MAP REFERENCE:  
"Subdivision Map for Verizon Wireless"  
Filed in the Rockland County Clerk's Office  
03/15/2004 as Map #7643.  
Subject Lot 1

DEED REFERENCE:  
Document # 2017-00040515  
Recorded 12/18/2017  
Grantor: Verizon Wireless  
Grantee: Sica Group LLC

GENERAL NOTES:  
To date, no Title Report or Abstract of Title has been provided. This survey is subject to a current, up to date Title Report.  
Property corner monuments were not placed as part of this survey.  
This map may not be used in connection with a "Survey Affidavit" or similar document, statement or mechanism to obtain title insurance for any subsequent or future grantees.  
Unauthorized alteration or addition to this survey is a violation of Section 2009, subdivision 2 of the New York State Education Law.  
The alteration of survey maps by anyone other than the original preparer is misleading, confusing and not in the general welfare and benefit of the public. Licensed Land Surveyors shall not alter survey maps, survey plans, or survey plats prepared by others.  
Underground structures, if any exist, are not shown hereon, except as noted. The location of underground improvements or encroachments are not always known and often must be estimated. If underground improvements, easements, or encroachments exist and are neither visible during normal field survey operations nor described in instruments provided to this surveyor, they may not be shown on this map and are not certified.  
Certifications indicated hereon signify that this survey was prepared in accordance with the existing Code of Practice for Land Surveys adopted by the New York State Association of Professional Land Surveyors, Inc. Said certifications shall run only to the person or entity for whom this survey was prepared and on their behalf to the title company, governmental agency and/or lending institution listed hereon, and to the assignees thereof.  
Certifications are not transferable to additional lending institutions or subsequent owners.  
This property may be affected by instruments which have not been provided to this surveyor. Users of this map should verify title with their attorney or a qualified title examiner.  
Only copies from the original of this survey marked with the surveyor's embossed seal are genuine, true and correct copies of the surveyor's original work and opinion. A copy of this document without a proper application of the surveyor's embossed seal should be assumed to be an unauthorized copy.

Area = 33.925 Acres

LEGEND

- Catch Basin
- Light Pole
- Manhole
- Sign
- Chain Link Fence
- CBRW - Conc. Bl. Ret. Wall
- Water Valve
- EP Electric Box
- Gas Valve

Legend- Aerial Topography

- ☆ BUSH-DECIDUOUS
- ☆ BUSH-EVERGREEN
- CATCH BASIN
- MANHOLE
- POLE
- SIGN
- STUMP
- TREE-DECIDUOUS
- TREE-EVERGREEN
- CONTOUR-INDEX
- CONTOUR-INTER
- CONTOUR INDEX-OBSCURED
- CONTOUR INTER-OBSCURED
- SPOT ELEVATION
- BRUSH LINE
- FENCE LINE
- LIGHT POLE
- PAINTED LINES
- RETAINING WALL
- STONE WALL
- TRAIL OR PATH
- TREE LINE

TELECOMMUNICATIONS MARKOUT

GAS LINE MARKOUT

ELECTRIC LINE MARKOUT

UNKNOWN LINE MARKOUT

WATER LINE MARKOUT

SEWER SERVICE

UNDERGROUND UTILITY MARKOUT PERFORMED BY UNDERGROUND SURVEYING OF BROOKFIELD, CT. ON 1-12-2022.

Now or Formerly  
Cable Ready Corp.

Now or Formerly  
David B. & Emily A. Rosen

Now or Formerly  
Leah F. Whittier

Now or Formerly  
Clifford & Elizabeth Powell

Now or Formerly  
Thomas R. & Andrea Whelan

Now or Formerly  
Jan-Craig & Qi Fan

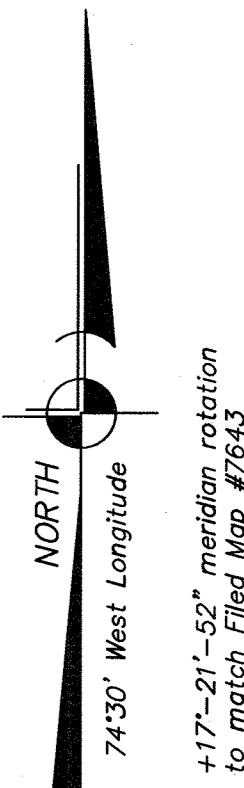
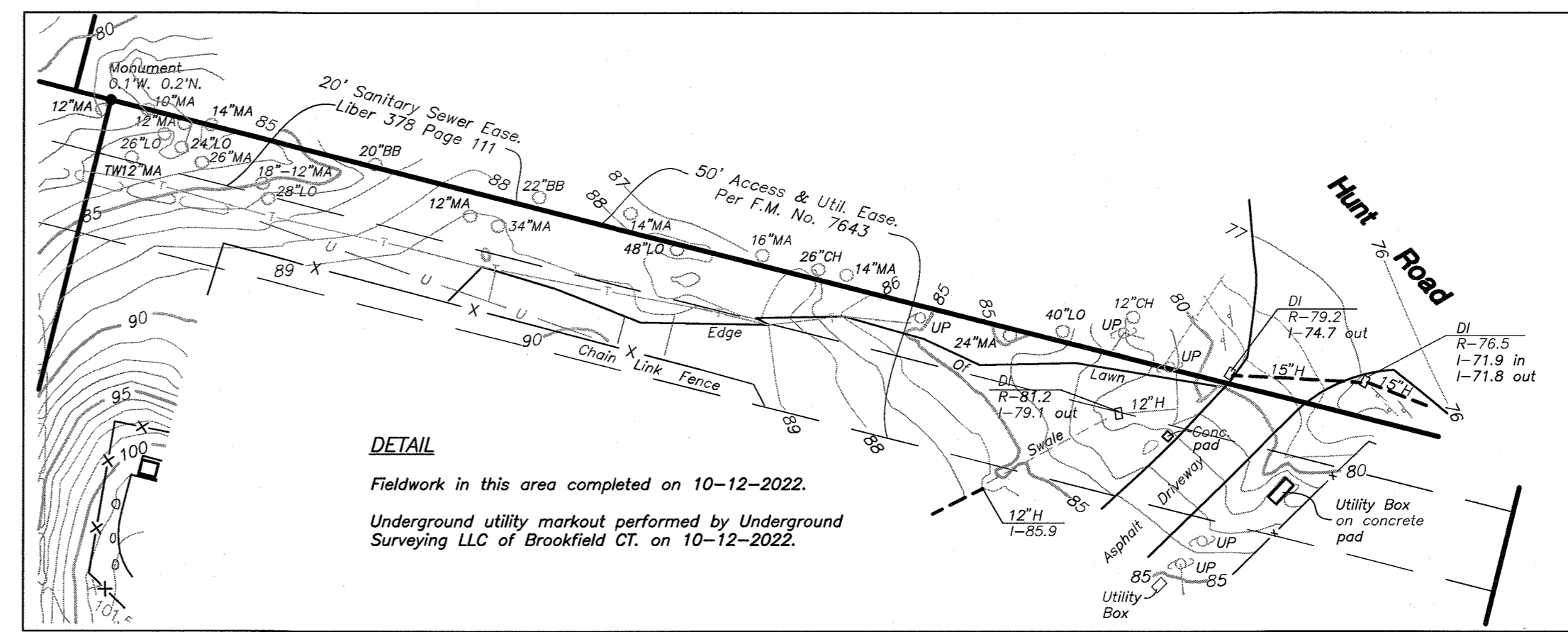

PHOTOGRAMMETRY BY:



270 Spangill Rd. Ste 205, Melville, NY 11747  
TEL: (516) 827-9100 FAX: (516) 827-9101

Map Scale: 1 inch = 50 feet  
Contour Interval: 1'

Photo Date: November 24, 2021  
Geomaps Job: 21-390

CORPORATE PARK DRIVE

Topographic and Planimetric details shown were derived from aerial photographs taken November 24, 2021 by Geomaps International.



3 Garrett Place  
Carmel, NY 10512  
(845) 225-9690  
(845) 225-9717 fax  
www.insite-eng.com

JEFFREY B. DAROSA, LS  
New York State License No. 050749  
© 2022 Insite Engineering, Surveying & Landscape Architecture, P.C. All Rights Reserved.

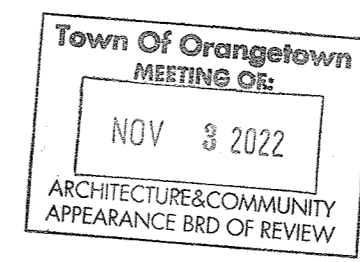

Topography Survey  
prepared for  
**Kimley Horn**  
Town of Orangetown  
Rockland County New York  
Scale 1" = 50'  
Date: March 24, 2022  
Revised: August 8, 2022  
October 25, 2022

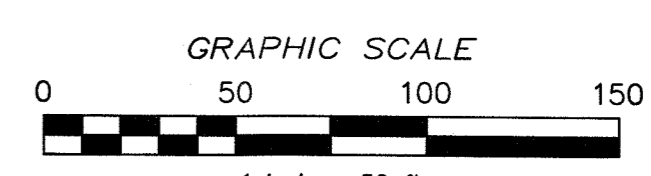

Horizontal Coord. = NAD83  
Vertical Datum = NAVD88