

Volta Gen4 L2 Station

Volta provides turn-key Electric Vehicle (EV) charging services for premium retail and entertainment destinations. We install and maintain the charging amenity at no cost to site partners as well as EV drivers, driving increased property value and attracting more customers who stay longer.

VOLTA STATION BENEFITS

- Installation, equipment and maintenance is paid by Volta
- Charges all electric vehicles
- Free electricity supported through third party content on displays
- Volta stations are occupied 80% of the retail day
- Volta has provided 88M free sponsored electric miles, delivered 25 gigawatt hours and eliminated over 39M pounds of CO2 emissions

CHARGING UNIT INFORMATION (Single Charging Units)

- Size: H 85.0" x W 36.5" x D 15.5"
- Display Size: H 48" x W 27
- Power Type: 208/240VAC, 48A, 10kW max; UL 2202
- Plug: SAE J1772 compliant connector

POWER REQUIREMENTS

- Charging unit: 60A/2P, 208/240 breaker
- Display/connectivity: 20A/1P, 120V breaker

INSTALLATION REQUIREMENTS

- Wire Diameter: #6 AWG minimum. Larger for longer conduit runs
- Conduit Diameter: 1.5" minimum per station. Larger conduit required for runs over 250'

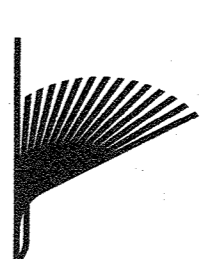

55" Media Display

Charges up to 30miles per hour

Universal J1772 connections

Cable Management

Fully Networked

Volta
155 DE HARO STREET
SAN FRANCISCO, CA 94103

Kimley»Horn
New York
© 2022 KIMLEY-HORN ENGINEERING AND
LANDSCAPE ARCHITECTURE OF NEW YORK
111 WHITE PLAINS RD., SUITE 505
WHITE PLAINS, NY 10601
PHONE: 914.388.9200
WWW.KIMLEY-HORN.COM

REV	DATE	DESCRIPTION	BY
1	05/11/2022	CD-100s	LJS

ISSUE DATE
05/11/2022

ISSUED FOR
PERMIT

FOR REFERENCE ONLY
DESIGNED AND PROVIDED BY OTHERS

IT IS A VIOLATION OF LAW FOR ANY PERSON,
UNLESS THEY ARE ACTING UNDER THE
DIRECTION OF A LICENSED PROFESSIONAL
ENGINEER, TO ALTER THIS DOCUMENT.

**STOP & SHOP #2545-
ORANGEBURG
COMMONS PHASE 1**
1 STEVENS WAY
ORANGEBURG, NY 10962

SHEET TITLE
**VOLTA STATION
OVERVIEW**

SHEET NUMBER
C0-02

APPROXIMATE PROPERTY LINE (TYP.)

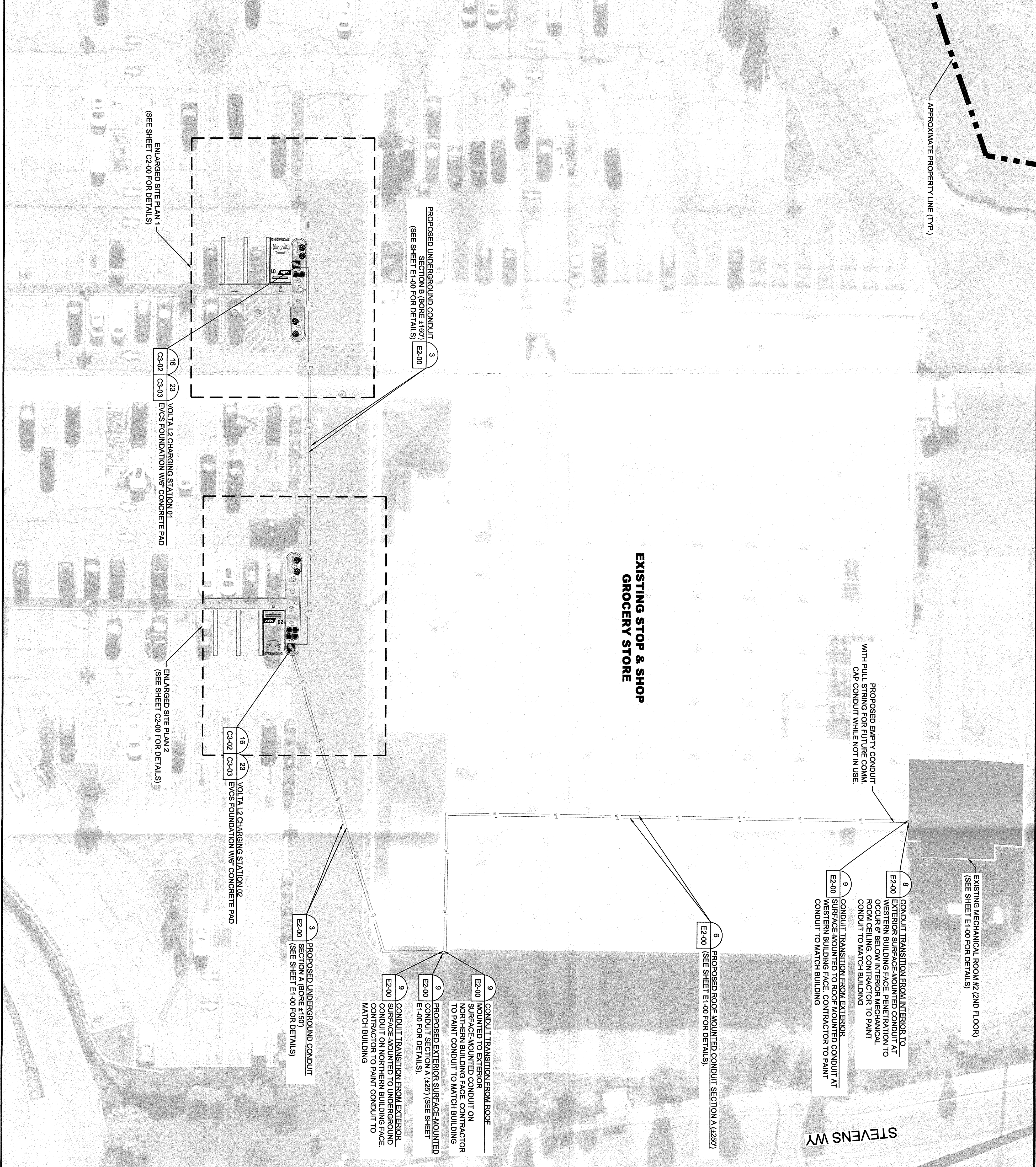

OVERALL SITE PLAN

NOTE: THE ORIGINAL SIZE OF THIS PLAN IS 24" X 36". SCALE RATIO IS NOT VALID FOR REDUCED OR ENLARGED SHEET SIZES

DISCLAIMER

THESE DRAWINGS WERE PRODUCED WITHOUT THE BENEFIT OF A CURRENT LAND SURVEY, ALL PROPERTY LINES, EASEMENTS, SETBACKS, EXISTING INFRASTRUCTURE AND TITLE DOCUMENTS. KIMLEY-HORN AND VOLTA DO NOT WARRANT THE ACCURACY OF SAID PROPERTY LINES, EASEMENTS, SETBACKS, EXISTING INFRASTRUCTURE AND TITLE DOCUMENTS.

CONTRACTOR IS RESPONSIBLE FOR VERIFYING ALL FIELD CONDITIONS AND IS TO ALERT THE ENGINEER AND VOLTA OF ANY DISCREPANCIES PRIOR TO STARTING CONSTRUCTION. CONTRACTOR TO COORDINATE WITH VOLTA PM FOR ALL FINAL PLACEMENTS OF INFRASTRUCTURE.

- CONSTRUCTION NOTES:**
- CONTRACTOR RESPONSIBILITIES CONSISTS OF, BUT NOT LIMITED TO, CHARGING STATION MOUNTING, FOUNDATION CONSTRUCTION, CONDUIT INSTALLATION, AND WIRING.
 - CONTRACTOR TO PAINT PROPOSED BY PARKING STALLS PER JURISDICTIONAL REQUIREMENTS.
 - CONTRACTOR TO INSTALL TREE PROTECTION FENCING PRIOR TO ANY CONSTRUCTION ACTIVITY. SEE SHEET C3-00 FOR DETAILS.
 - EXACT STATION PLACEMENT AND ROTATION ANGLE MAY VARY SLIGHTLY UPON INSTALLATION DEPENDING ON SITE CONDITIONS.
 - EQUIPMENT LOCATIONS TO ENSURE SUFFICIENT SPACE IS AVAILABLE. CONTRACTOR SHALL TAKE NECESSARY PRECAUTIONS WHEN DRILLING INTO EXISTING CIP SLAB AND CIP DROP PANELS TO AVOID DAMAGE TO ANY REINFORCING AND EXISTING STRUCTURAL COMPONENTS.
 - USE APPROVED ASTM METHOD (X-RAY, PACOMETER, GPR, ETC.) TO LOCATE MILD STEEL AND PRE-STRESSING TENDONS PRIOR TO DRILLING. DO NOT CUT OR DRILL THROUGH ANY EXISTING REINFORCING. ADJUST LOCATION AS NECESSARY TO AVOID EXISTING ANCHORAGE. ENSURE 1" GAP MIN. BETWEEN REBAR AND CONDUIT.
 - VOLTA WILL MAKE EVERY EFFORT TO FOLLOW WITH THEIR PROPOSED CONDUIT. AN EXISTING CONDUIT ROUTE FROM ELECTRICAL ROOM IS NOT AVAILABLE. VOLTA WILL MAKE EVERY EFFORT TO CONCEAL/HAIDE, PAINT AND MINIMIZE VISUAL IMPACT OF CONDUITS ANYWHERE THEY MAY BE VISIBLE TO THE PUBLIC.
 - CONTRACTOR IS RESPONSIBLE TO LOCATE ALL VERTICAL AND HORIZONTAL UTILITIES PRIOR TO DIRECTIONAL BORING. ANY ALTERATIONS TO THE PROPOSED CONDUIT ROUTE ARE TO BE COORDINATED WITH THE PROFESSIONAL ENGINEER(S) PRIOR TO CONSTRUCTION.
 - ANY ITEMS TO REMAIN THAT ARE DAMAGED BY THE CONTRACTOR SHALL BE REPLACED TO THE EXISTING CONDITION OR BETTER AT THE CONTRACTOR'S EXPENSE.
 - CONTRACTOR TO LOCATE JUNCTION BOX OR APPROVED ALTERNATIVE FOR SITE SPECIFIC ROUNLENGTHS AND BENDS.
 - ACTION FROM PLAN ON THE PROPOSED CONDUIT METHOD IS AT CONTRACTOR'S RISK AND VOLTA WILL NOT BE RESPONSIBLE FOR DAMAGES ON EXISTING UNDERGROUND FIELD CONDITIONS. ANY DEVIATIONS SHALL BE APPROVED BY VOLTA AND THE SITE HOST. CONTRACTORS TO ENSURE ALL CONDUIT INSTALLATION METHODS ARE APPROVED BY LOCAL JURISDICTION AND INSPECTOR.

- PARKING NOTE:**
- THIS PROJECT PROPOSES TO UPGRADE (2) STANDARD PARKING STALLS TO (2) EV PARKING STALLS FOR EV READINESS. NO NET CHANGE IN PARKING IS PROPOSED.
- REFERENCE NOTE:**
- SEE PROJECT LEGEND ON SHEET C0-01 FOR SYMBOLS AND LINE TYPE DESCRIPTIONS.

IMAGE REFERENCE:

AERIAL IMAGES PROVIDED BY NEARMAP
IMAGERY ©2022 Nearmap, HERE

nearmap
current | clear | change

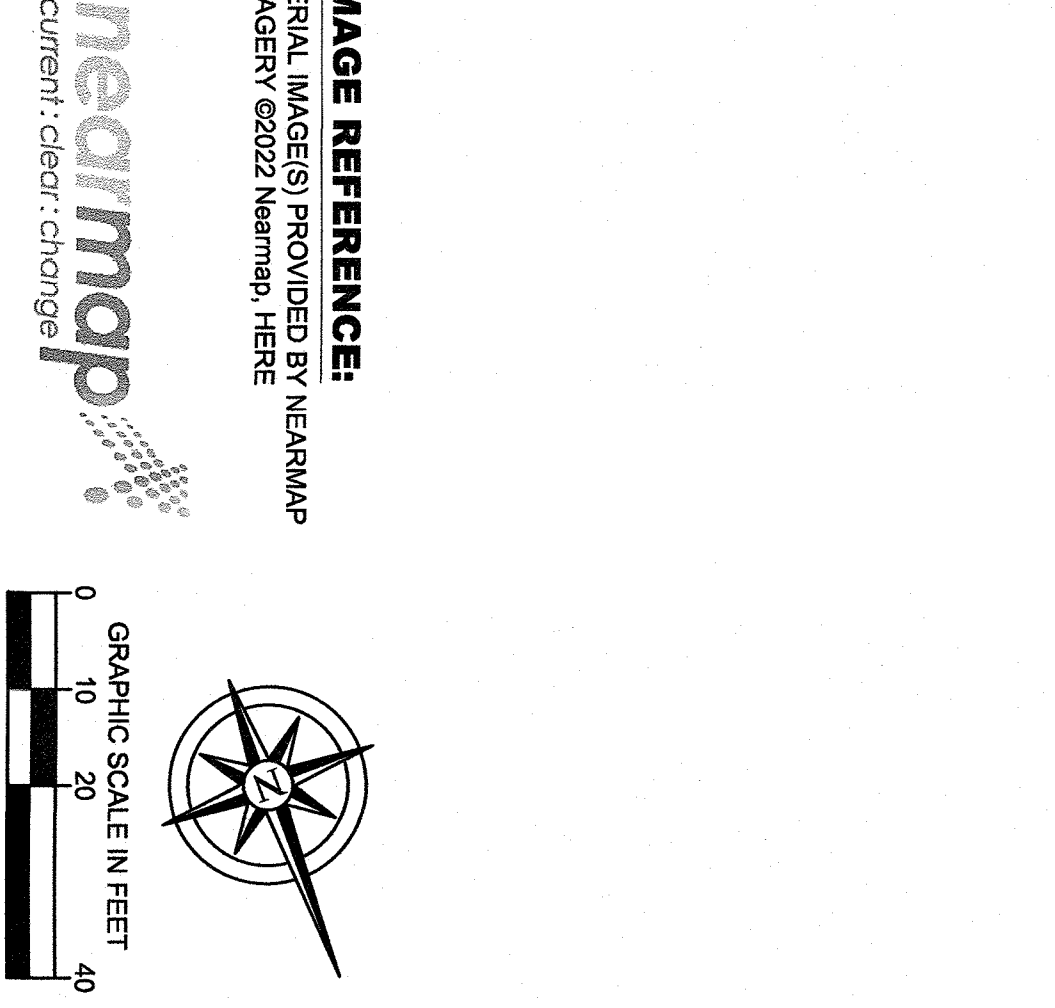

Volta

155 DE HARO STREET
SAN FRANCISCO, CA 94103

Kimley-Horn
New York
© 2022 KIMLEY-HORN ENGINEERING AND LANDSCAPE ARCHITECTURE OF NEW YORK
1 N LEVINGTON AVE, SUITE 505
WHITE PLAINS, NY 10601
PHONE: 914.388.9200
WWW.KIMLEY-HORN.COM

REV	DATE	DESCRIPTION	BY
1	05/11/2022	CD-100s	JJS

ISSUE DATE
05/11/2022

ISSUED FOR
PERMIT

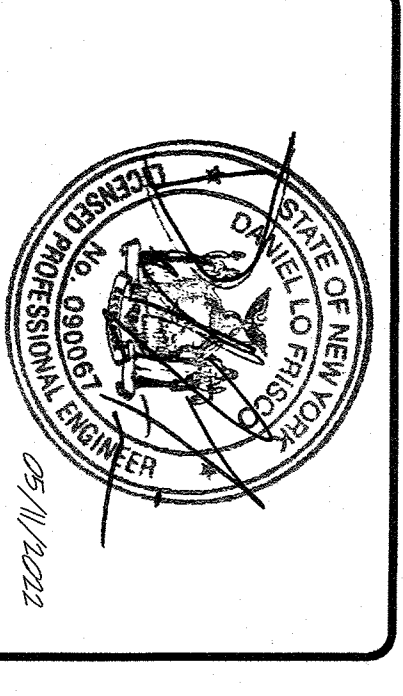

THIS IS A VIOLATION OF LAW FOR ANY PERSON, DIRECTOR OF A LICENSED PROFESSIONAL ENGINEER, TO ALTER THIS DOCUMENT.

STOP & SHOP #2545-ORANGEBURG COMMONS PHASE 1
1 STEVENS WAY
ORANGEBURG, NY 10962

SHEET TITLE
OVERALL SITE PLAN

SHEET NUMBER
C1-00